

ACU

PUBLICATION NUMBER PL-04195-02
February 5, 2008

Use With: OM-04151
MR-04204



PUMP MODELS
S8C18 460V 3P
S8C18 575V 3P

MANUAL
PART 2 of 3

PARTS
LIST
WITH
PERFORMANCE CURVE

THE GORMAN-RUPP COMPANY • MANSFIELD, OHIO

www.grpumps.com

GORMAN-RUPP OF CANADA LIMITED • ST. THOMAS, ONTARIO, CANADA

Printed in U.S.A.

©2008 The Gorman-Rupp Company

Register your new
Gorman-Rupp pump online at
www.grpumps.com

Valid serial number and e-mail address required.

RECORD YOUR PUMP MODEL AND SERIAL NUMBER

Please record your pump model and serial number in the spaces provided below. Your Gorman-Rupp distributor needs this information when you require parts or service.

Pump Model: _____

Serial Number: _____

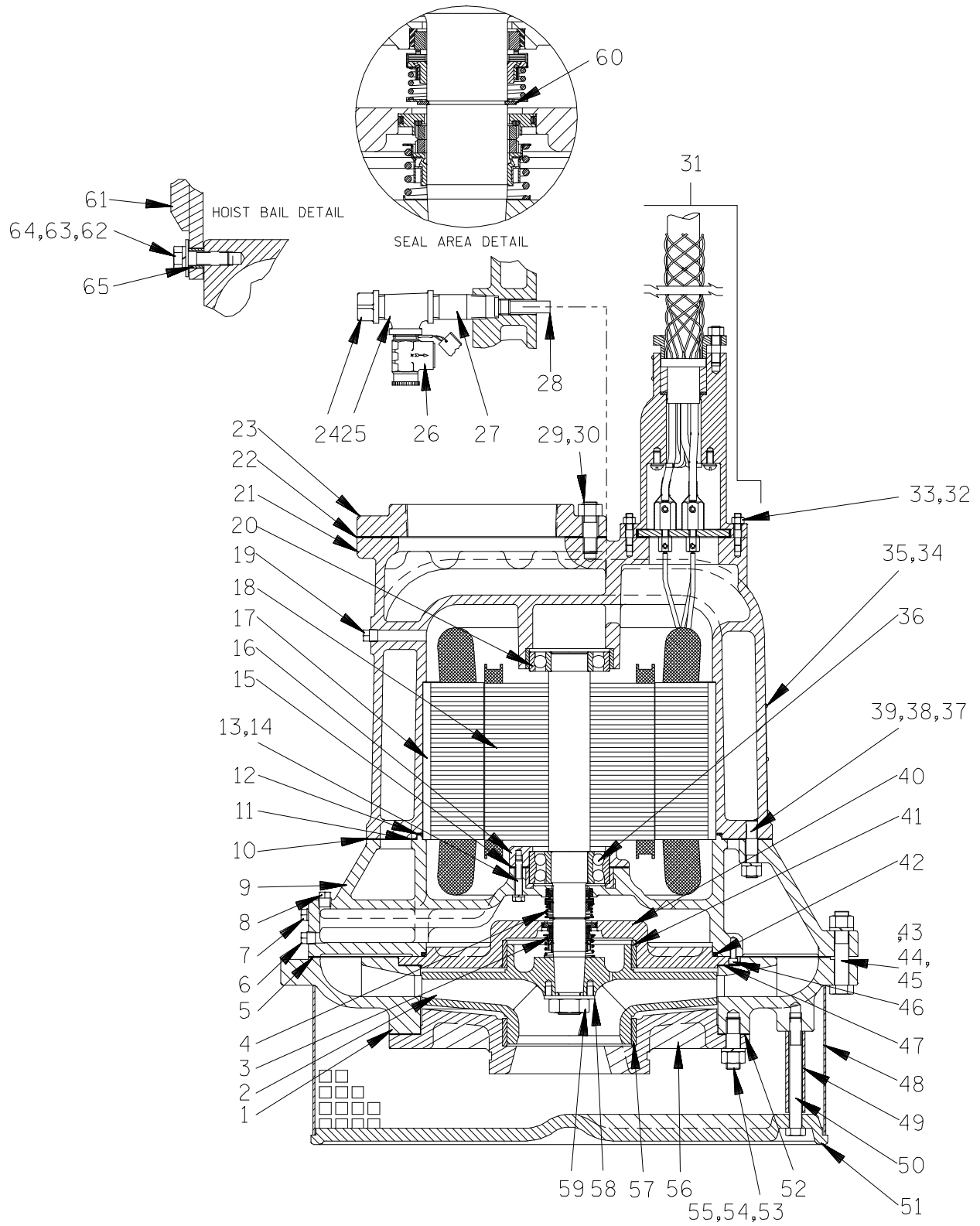

THE GORMAN-RUPP COMPANY • MANSFIELD, OHIO

GORMAN-RUPP OF CANADA LIMITED • ST. THOMAS, ONTARIO, CANADA Printed in U.S.A.

S8C18 460V/575V 3P

ACU

S/N 1527885 UP

PUMP ISSUE 2

If your pump serial number is followed by an "N", your pump is NOT a standard production model. Contact the Gorman-Rupp Company to verify part numbers.

ITEM NO.	PART NAME	PART NUMBER	MAT'L CODE	QTY	ITEM NO.	PART NAME	PART NUMBER	MAT'L CODE	QTY
1	DIFFUSER	38632-023	1718H	1	46	SOC HD CAPSCREW	BD0503	17000	6
2 *	IMPELLER	38623-517	1718H	1	47 *	GASKET	38682-812	20000	1
3 *	LOWER SEAL ASSY	46512-055	----	1	48	STRAINER SCREEN	10090	1599V	1
4 *	UPPER SEAL ASSY	25271-947	----	1	49	PIPE	31413-026	15079	6
5 *	DIFFUSER GASKET	38682-813	20000	1	50	HEX HD CAPSCREW	B1024	17000	6
6	SEAL CAVITY PIPE PLUG P06		17000	1	51	BASE PLATE	10036	13080	1
7	MTR CAVITY DRAIN PLUG P06		17000	1	52 *	GASKET	38683-817	20000	1
8	MTR CAVITY FILL PLUG P06		17000	1	53	STUD	C1211	1706G	8
9	INTERMEDIATE	38261-022	13040	1	54	HEX NUT	D12	17000	8
10 *	GASKET	38684-703	20000	1	55	LOCK WASHER	J12	17000	8
11 *	GASKET	10062G	20000	1	56	SUCTION HEAD	38246-033	1718H	1
12 *	GASKET	10038G	20000	1	57 *	WEAR RING	38691-309	14000	1
13	HEX HD CAPSCREW	B0608	15991	4	58 *	IMPELLER WASHER	11199	17000	1
14	LOCK WASHER	J06	15991	4	59 *	JAM NUT	AT20S	17000	1
15	GASKET	10085G	20000	1	60	RETAINING RING	S264	----	1
16	BEARING CAP	10085	10010	1	61	BAIL	10039	2400V	1
17	STATOR ASSY	47113-077	----	1	62	HEX HD CAPSCREW	B1210	17000	2
18	ROTOR & SHAFT ASSY	47112-077	----	1	63	LOCK WASHER	J12	17000	2
19	PIPE PLUG	P06	17000	1	64	FLAT WASHER	K12	17000	2
20 *	BALL BEARING	S1077	----	1	65	BUSHING	10045	15071	2
21	MOTOR HOUSING	42822-015	24130	1	NOT SHOWN:				
22 *	GASKET	1759G	18000	1	CONTROL BOX				
23	FLANGE	1759	10010	1	-460V 27515-507 ---- 1				
24	PIPE CAP	V16	11999	1	-575V 27515-517 ---- 1				
25	STREET TEE ASSY	14138	----	1	* 1 QT SUB MOTOR OIL 9568 ---- 1				
26 *	PRESS RELIEF VLV ASSY	14139	----	1	MOTOR VOLTAGE TAG				
27	PIPE NIPPLE	THA1614	15079	1	-460V 6588BL ---- 1				
28	FILL TUBE ASSY	10040	24040	1	-575V 6588BM ---- 1				
29	STUD	C1211	17060	8	IMP KNOCKER 2177C 14070 1				
30	HEX NUT	D12	17000	8	HEATER PACK				
31	TERM HSG & CBL ASSY	47367-061	----	1	-460V 27521-220 ---- 1				
32	STUD	C0607	17000	6	-575V 27521-219 ---- 1				
33	DEFORM LOCK NUT	DD06	17000	6	OPTIONAL:				
34	DRIVE SCREW	BM#04-03	17000	6	REPAIR GASKET SET 11000V ---- 1				
35	NAME PLATE	2613CY	17020	1	HEAT-SHRINK TUBE & ADHESIVE KIT 48315-004 ---- 1				
36 *	BALL BEARING	23431-461	----	1	TERM POTTING KIT 12442A ---- 1				
37	STUD	10443	1706G	12	ANODE PLATE ASSY 42116-002 ---- 1				
38	HEX NUT	D10	17000	12	LIQUID LEVEL DEVICES:				
39	LOCK WASHER	J10	17000	12	DIAPHRAGM TYPE GRP48-03 ---- 1				
40	SEAL PLATE	38272-707	1718H	1	GRP48-06 ---- 1				
41 *	WEAR RING	38691-309	14000	1	FLOAT TYPE 27471-180 ---- 1				
42 *	O-RING	S2207	----	1	LIQ LEV CONTRL RELAY 27521-321 ---- 1				
43	HEX HD CAPSCREW	B1216	17000	20					
44	HEX NUT	D12	17000	20					
45	LOCK WASHER	J12	17000	20					

* INDICATES PARTS RECOMMENDED FOR STOCK

THE GORMAN-RUPP COMPANY • MANSFIELD, OHIO

GORMAN-RUPP OF CANADA LIMITED • ST. THOMAS, ONTARIO, CANADA Printed in U.S.A.

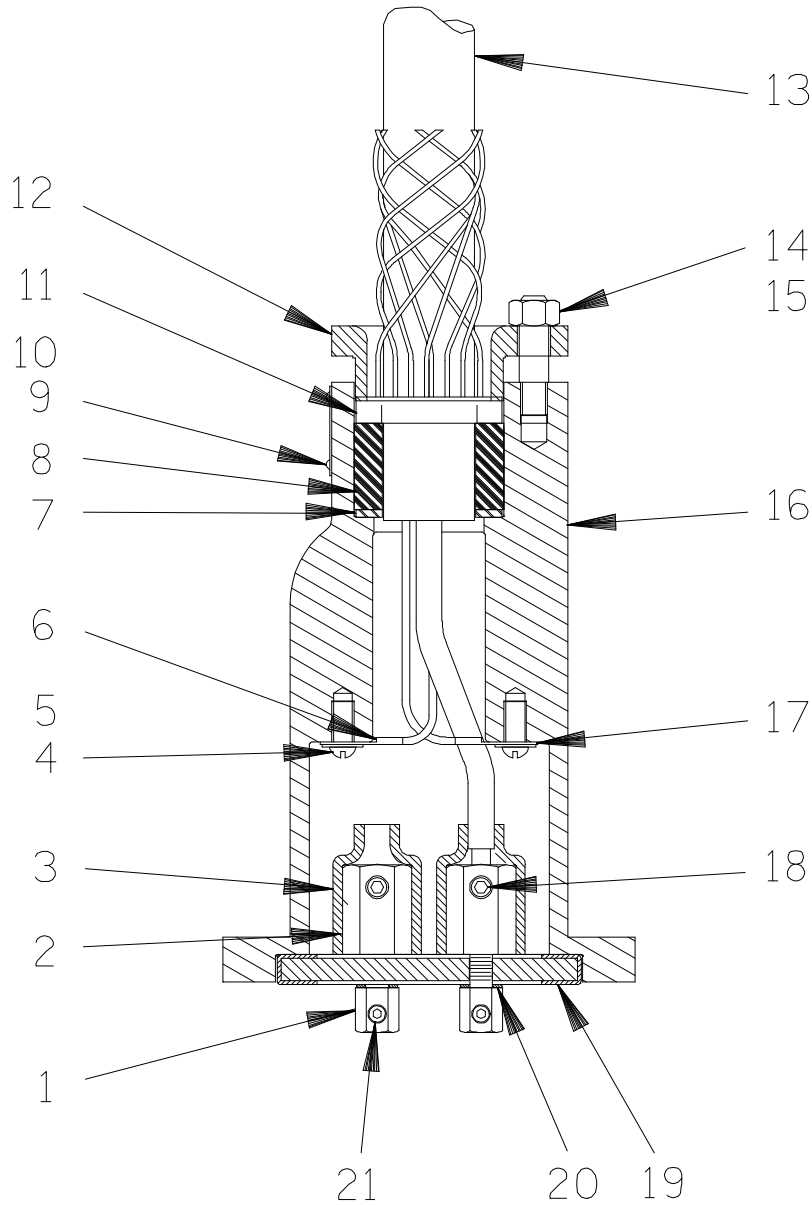

THE GORMAN-RUPP COMPANY • MANSFIELD, OHIO

GORMAN-RUPP OF CANADA LIMITED • ST. THOMAS, ONTARIO, CANADA Printed in U.S.A.

S8C18 460V/575V 3P

ACU

S/N 1527885 UP

PUMP ISSUE 2

460V 3P Terminal Housing And Cable Assembly 47367-061

If your pump serial number is followed by an "N", your pump is **NOT** a standard production model. Contact the Gorman-Rupp Company to verify part numbers.

ITEM NO.	PART NAME	PART NUMBER	MAT'L CODE	QTY
1	TERMINAL POST	38724-009	14100	3
2	TERMINAL COLLAR	10052A	14100	3
3	* HEAT-SHRINK TUBE	31417-030	19530	3
4	T-TYPE LOCKWASHER	AK06	15991	2
5	RD HD MACH SCREW	X0603	14990	2
6	TERMINAL	27214-035	---	1
7	TERMINAL WASHER	10659B	15991	1
8	* GLAND BUSHING	10758E	19100	1
9	INFORMATION PLATE	38816-047	17990	1
10	DRIVE SCREW	BM#04-03	17000	4
11	* CABLE GRIP	11227F	---	1
12	TERMINAL GLAND	10658	13040	1
13	* POWER CABLE	10325A	---	1
14	HEX NUT	D08	15991	2
15	STUD	C0808	15991	2
16	TERMINAL HOUSING	10088B	13040	1
17	TERMINAL	27214-062	---	1
18	AL HD SETSCREW	GA0602	14990	3
19	* TERMINAL PLT ASSY	11163	24010	1
20	* DYNA SEAL WASHER	S1586	---	3
21	AL HD SETSCREW	GA0501 1/2	14990	3

NOT SHOWN:

2 OZ RTV SEALANT 18771-106 --- 1

OPTIONAL:

HEAT SHRINK TERMINAL KIT 48315-004 --- 1

* INDICATES PARTS RECOMMENDED FOR STOCK

THE GORMAN-RUPP COMPANY • MANSFIELD, OHIO

GORMAN-RUPP OF CANADA LIMITED • ST. THOMAS, ONTARIO, CANADA Printed in U.S.A.

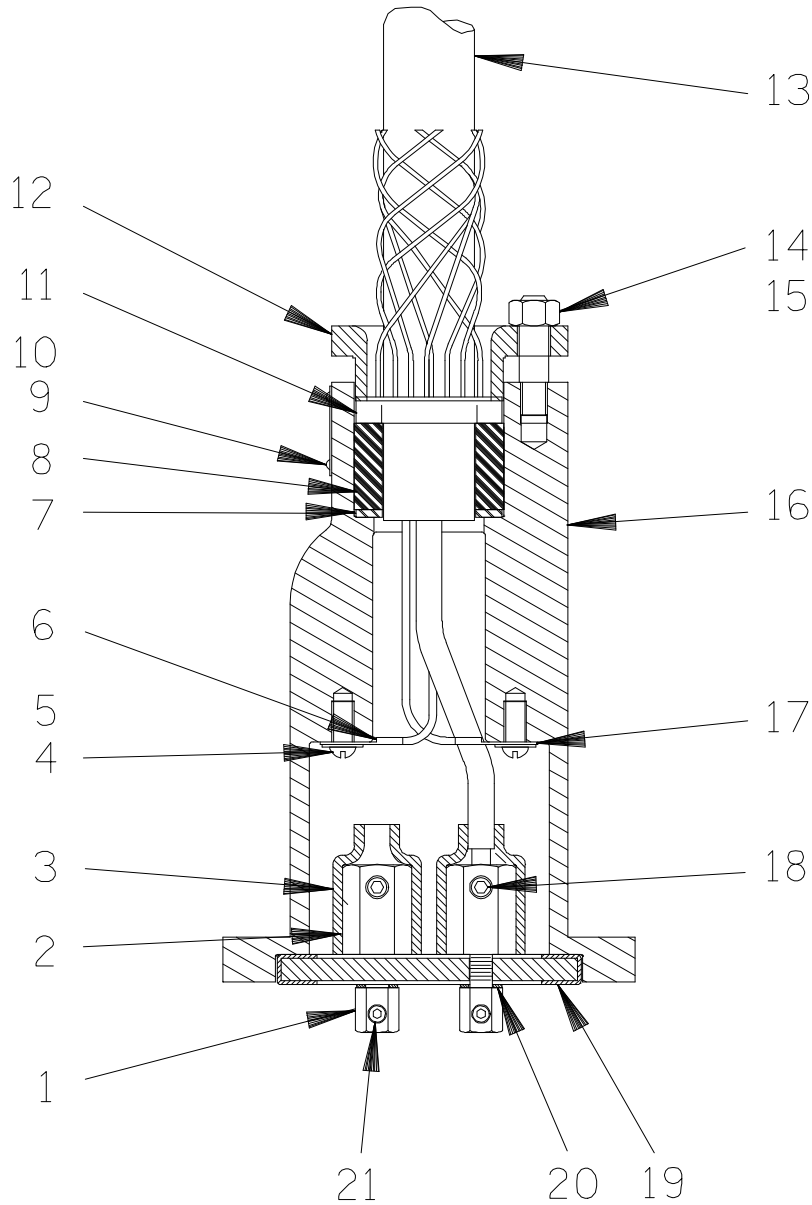

THE GORMAN-RUPP COMPANY • MANSFIELD, OHIO

GORMAN-RUPP OF CANADA LIMITED • ST. THOMAS, ONTARIO, CANADA Printed in U.S.A.

S8C18 460V/575V 3P

ACU

S/N 1527885 UP

PUMP ISSUE 2

575V 3P Terminal Housing And Cable Assembly 47367-028

If your pump serial number is followed by an "N", your pump is **NOT** a standard production model. Contact the Gorman-Rupp Company to verify part numbers.

ITEM NO.	PART NAME	PART NUMBER	MAT'L CODE	QTY
1	TERMINAL POST	38724-009	14100	3
2	TERMINAL COLLAR	10052A	14100	3
3	* HEAT-SHRINK TUBE	31417-030	19530	3
4	T-TYPE LOCKWASHER	AK06	15991	2
5	RD HD MACH SCREW	X0603	14990	2
6	TERMINAL	27214-062	---	1
7	TERMINAL WASHER	31133-110	15991	1
8	* GLAND BUSHING	31144-001	19100	1
9	INFORMATION PLATE	38816-047	17990	1
10	DRIVE SCREW	BM#04-03	17000	4
11	* CABLE GRIP	11227H	---	1
12	TERMINAL GLAND	10658	13040	1
13	* POWER CABLE	10325L	---	1
14	HEX NUT	D08	15991	2
15	STUD	C0808	15991	2
16	TERMINAL HOUSING	10088B	13040	1
17	TERMINAL	S1550	---	1
18	AL HD SETSCREW	GA0602	14990	3
19	* TERMINAL PLT ASSY	11163	24010	1
20	* DYNA SEAL WASHER	S1586	---	3
21	AL HD SETSCREW	GA0501 1/2	14990	3

NOT SHOWN:

1 OZ RTV SEALANT	18771-106	---	1
------------------	-----------	-----	---

* INDICATES PARTS RECOMMENDED FOR STOCK

THE GORMAN-RUPP COMPANY • MANSFIELD, OHIO

GORMAN-RUPP OF CANADA LIMITED • ST. THOMAS, ONTARIO, CANADA Printed in U.S.A.

**For U.S. and International Warranty Information,
Please Visit www.grpumps.com/warranty
or call:
U.S.: 419-755-1280
International: +1-419-755-1352**

**For Canadian Warranty Information,
Please Visit www.grcanada.com/warranty
or call:
519-631-2870**