

ACSU

Use With: OM-04151  
MR-04152

PUBLICATION NUMBER PL-04683-01

May 1, 1997

Rev. B 02/10/06

Supersedes: PL-04681-01

PL-04682-01

PL-04684-01



**PUMP MODELS**  
**S4H1-E10**  
**200/230/460/575/3**

**MANUAL**  
**PART 2 of 3**

**PARTS**  
**LIST**  
**WITH**  
**PERFORMANCE CURVE**

**THE GORMAN-RUPP COMPANY • MANSFIELD, OHIO**

[www.gormanrupp.com](http://www.gormanrupp.com)

**GORMAN-RUPP OF CANADA LIMITED • ST. THOMAS, ONTARIO, CANADA**

Printed in U.S.A.

©Copyright by the Gorman-Rupp Company



SEAL AREA DETAIL

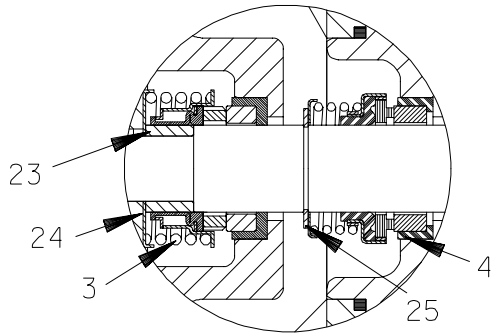

HOIST BAIL DETAIL

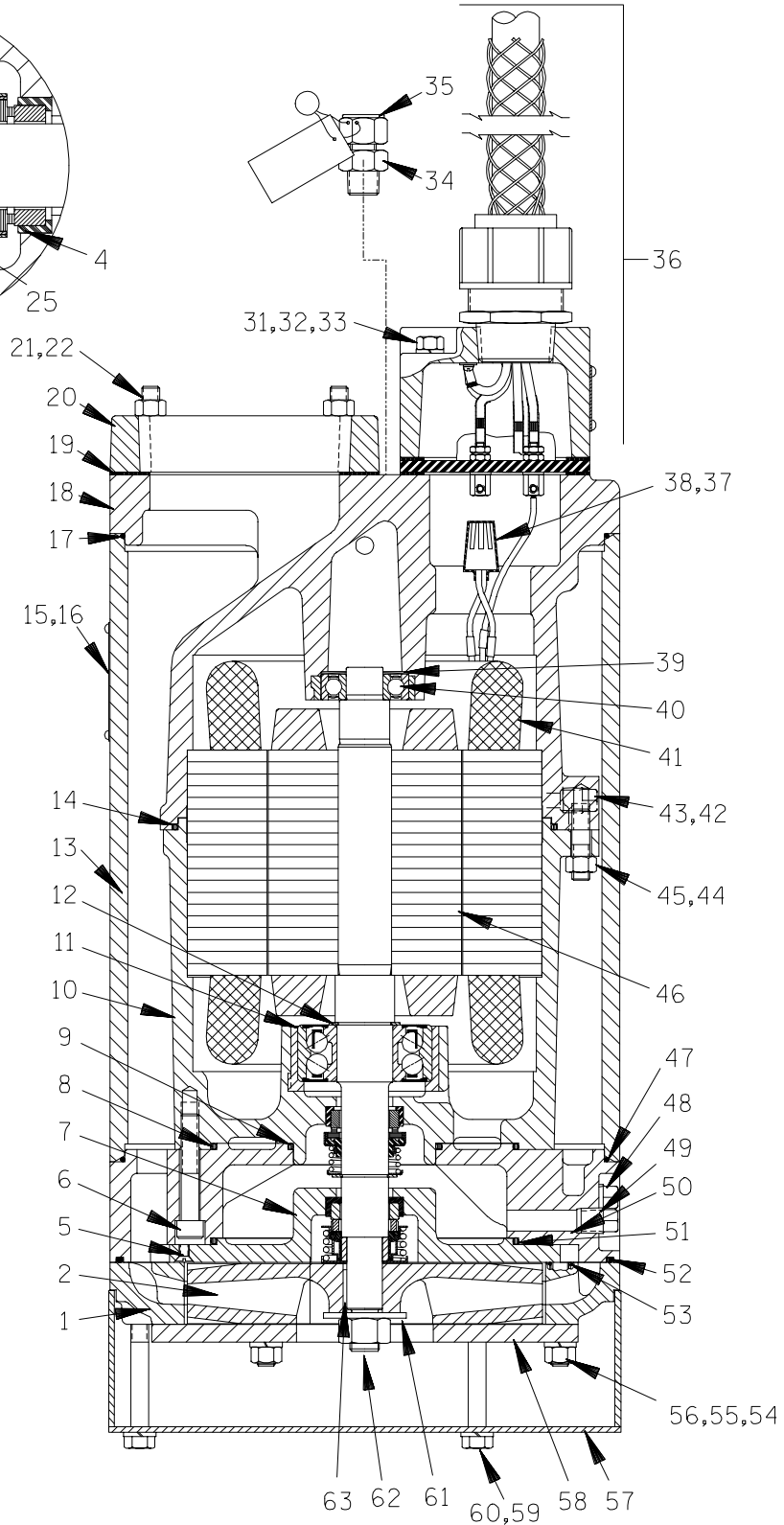
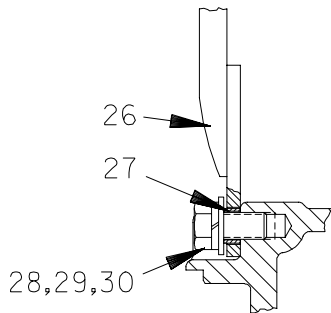

**THE GORMAN-RUPP COMPANY • MANSFIELD, OHIO**

GORMAN-RUPP OF CANADA LIMITED • ST. THOMAS, ONTARIO, CANADA

Printed in U.S.A.

MAY 1, 1997

Rev. B 02/10/06

©Copyright by the Gorman-Rupp Company

1 of 6

Page 150.4 H7

**S/N 1129913 Up  
PUMP ISSUE 1**

If your pump serial number is followed by an "N", your pump is **NOT** a standard production model. Contact the Gorman-Rupp Company to verify part numbers.

ITEM NO.	PART NAME	PART NUMBER	MAT'L CODE	QTY	ITEM NO.	PART NAME	PART NUMBER	MAT'L CODE	QTY
1	DIFFUSER	38632-061	1102H	1	45	DEFORM LOCK NUT	DD06	17000	8
2 *	IMPELLER	38622-519	1102H	1	46	ROTOR W/SHAFT	47112-816	----	1
3 *	SEAL ASSY	46512-057	----	1	47 *	O-RING	S1830	----	1
4	SEAL	S1832	----	1	48	MTR CAVITY DRAIN PLUG	P04	17000	1
5	MACH SCREW	Y#10-03	17000	3	49	SEAL CVTY DRAIN PLUG	P04	17000	1
6	SOC HD CAPSCREW	DM0609	17000	3	50	INTERMEDIATE	13883	13040	1
7	SEAL PLATE	13882	1102H	1	51 *	O-RING	25152-259	----	1
8 *	O-RING	25152-259	----	1	52 *	O-RING	S1830	----	1
9 *	O-RING	25152-234	----	1	53 *	O-RING	25152-012	----	3
10	MOTOR HOUSING	38311-049	13040	1	54	STUD	C0612	17000	3
11 *	BALL BEARING	23431-303	----	1	55	LOCK WASHER	J06	17000	3
12	SNAP RING	S1831	----	1	56	HEX NUT	D06	17000	3
13	PUMP CASING	11982	13175	1	57	STRAINER ASSY	11969	2400V	1
14 *	O-RING	25152-265	----	1	58 *	WEAR PLATE	11948A	15010	1
15	NAME PLATE	38814-055	17000	1	59	HEX HD CAPSCREW	B0612	15991	3
16	DRIVE SCREW	BM#04-03	17000	4	60	LOCK WASHER	J06	15991	3
17 *	O-RING	S1830	----	1	61	FLAT WASHER	KB10	17000	1
18	UPPER MOTOR HSG	38311-058	13000	1	62	HEX NUT	D10S	17000	1
19 *	GASKET	11957G	20000	1	63 *	KEY	N0303 1/2	17000	1
20	DISCH FLANGE	11957	13040	1	NOT SHOWN:				
21	STUD	C0609	15991	4		CABLE TIE	27111-212	----	1
22	HEX NUT	D06	15991	4		MOTOR PLATE			
23 *	SHAFT SLEEVE	13878	17020	1		-230/3 460/3	10436	17000	1
24 *	ADJ SHIM SET	2Y	17090	1		DRIVE SCREW			
25 *	RETAINING RING	S362	----	1		-230/3 460/3	BM#04-03	17000	4
26	HOIST BAIL	11959	2400V	1		QTS SUB PUMP OIL	9568	----	1
27 *	BUSHING	9562	15991	2		VOLTAGE TAG			
28	HEX HD CAPSCREW	B0804	15991	2		-200/3 & 230/3	6588Z	----	1
29	LOCK WASHER	J08	15991	2		-460/3	6588AA	----	1
30	FLAT WASHER	KE08	15991	2		-575/3	38816-128	----	1
31	STUD	C0513	15991	4		INSTRUCTION TAG	6588AC	----	1
32	LOCK WASHER	J05	15991	4		CONTROL BOX			
33	HEX NUT	D05	15991	4		-200/3	27515-554	----	1
34	RED PIPE BUSH	AP0604	15079	1		-230/3	27515-504	----	1
35	RELIEF VLV ASSY	46431-608	----	1		-460/3	27515-503	----	1
36	TERM HSG & CAB ASSY					-575/3	27515-513	----	1
	-200/3, 230/3, 460/3	47367-062	----	1		HEATER PACK			
	-575/3	47367-053	----	1		-200/3	27521-208	----	1
37	CONNECTOR	S1718	----	3		-230/3	27521-207	----	1
38	HEAT SHRINK TUBE	31411-235	19450	3		-460/3	27521-205	----	1
39	SPRING WASHER	S1554	----	1		-575/3	27521-204	----	1
40 *	BALL BEARING	S1044	----	1	OPTIONAL:				
41	STATOR					STAGING ADAPTOR KIT	48272-013	----	1
	-200/3	47113-843	----	1		ANODE PLATE ASSY	42116-003	----	1
	-230/3 & 460/3	47113-844	----	1		REPAIR GASKET SET	11000AK	----	1
	-575/3	47113-846	----	1		LIQUID LEVEL DEVICES:			
42	ALLEN HD SETSCREW	GA0501 1/4	15990	2		-DIAPHRAGM TYPE	GRP48-03 or GRP48-06		1
43	PIPE PLUG	38649-022	17030	2		-FLOAT SWITCH	27471-180	----	1
44	STUD	C0606	17000	8		-120V LIQ LVL CTRL SW	27521-321	----	1

\* INDICATES PARTS RECOMMENDED FOR STOCK

**THE GORMAN-RUPP COMPANY • MANSFIELD, OHIO**

GORMAN-RUPP OF CANADA LIMITED • ST. THOMAS, ONTARIO, CANADA

Printed in U.S.A.

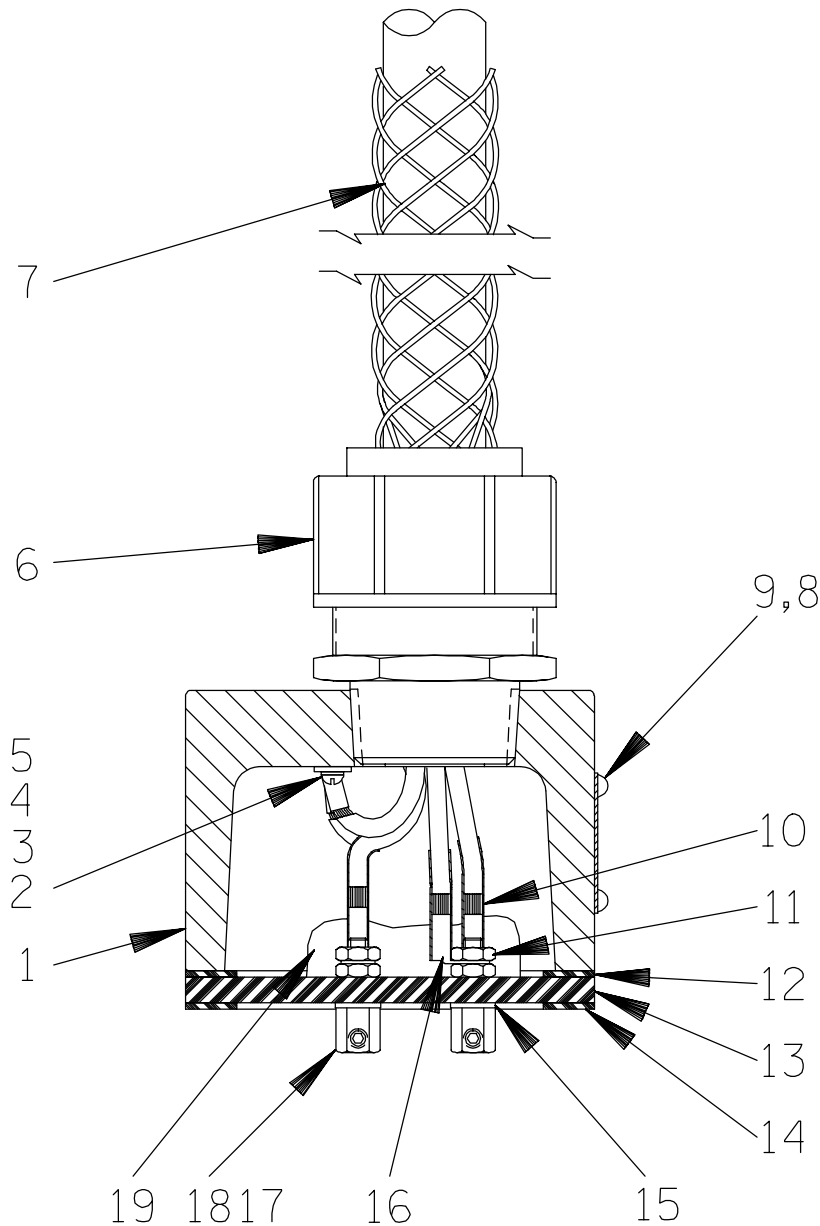

**THE GORMAN-RUPP COMPANY • MANSFIELD, OHIO**

GORMAN-RUPP OF CANADA LIMITED • ST. THOMAS, ONTARIO, CANADA

Printed in U.S.A.

MAY 1, 1997

Rev. B 02/10/06

©Copyright by the Gorman-Rupp Company

3 of 6

Page 150.4 H7

**S/N 1129913 Up  
PUMP ISSUE 1**

**Terminal Housing 47367—062 (200/3, 230/3 And 460/3)**

If your pump serial number is followed by an "N", your pump is **NOT** a standard production model. Contact the Gorman-Rupp Company to verify part numbers.

ITEM NO.	PART NAME	PART NUMBER	MAT'L CODE	QTY
1	TERMINAL HOUSING	38381—230	13040	1
2	RD HD MACHINE SCREW	X#10—02	15991	2
3	T-TYPE LK WASHER	AK#10	15991	2
4	TERMINAL SK—E 26U	27214—243	----	1
5	TERMINAL SK—C 36U	S1836	----	1
6	CABLE GRIP ASSY	27111—026	----	1
7	* CABLE	10325T	----	1
8	INFO PLATE	38816—047	17990	1
9	DRIVE SCREW	BM#04—03	17000	4
10	* HEAT-SHRINK TUBE	31411—233	19530	3
11	HEX NUT	D#10	14990	6
12	* GASKET	38687—525	20000	1
13	TERM PLATE	38713—008	23010	1
14	GASKET	38687—525	20000	1
15	* DYNA-SEAL WASHER	S1590	----	3
16	TERMINAL SK—D 36U	S1835	----	3
17	TERMINAL	11181	14100	3
18	ALLEN HD SETSCREW	GA#10—01S	15991	3
19	RTV SEALANT	18771—106	----	1
OPTIONAL:				
	HEAT SHRINK TERMINAL KIT	48315—006	----	1

\* INDICATES PARTS RECOMMENDED FOR STOCK

**THE GORMAN-RUPP COMPANY • MANSFIELD, OHIO**

GORMAN-RUPP OF CANADA LIMITED • ST. THOMAS, ONTARIO, CANADA

Printed in U.S.A.

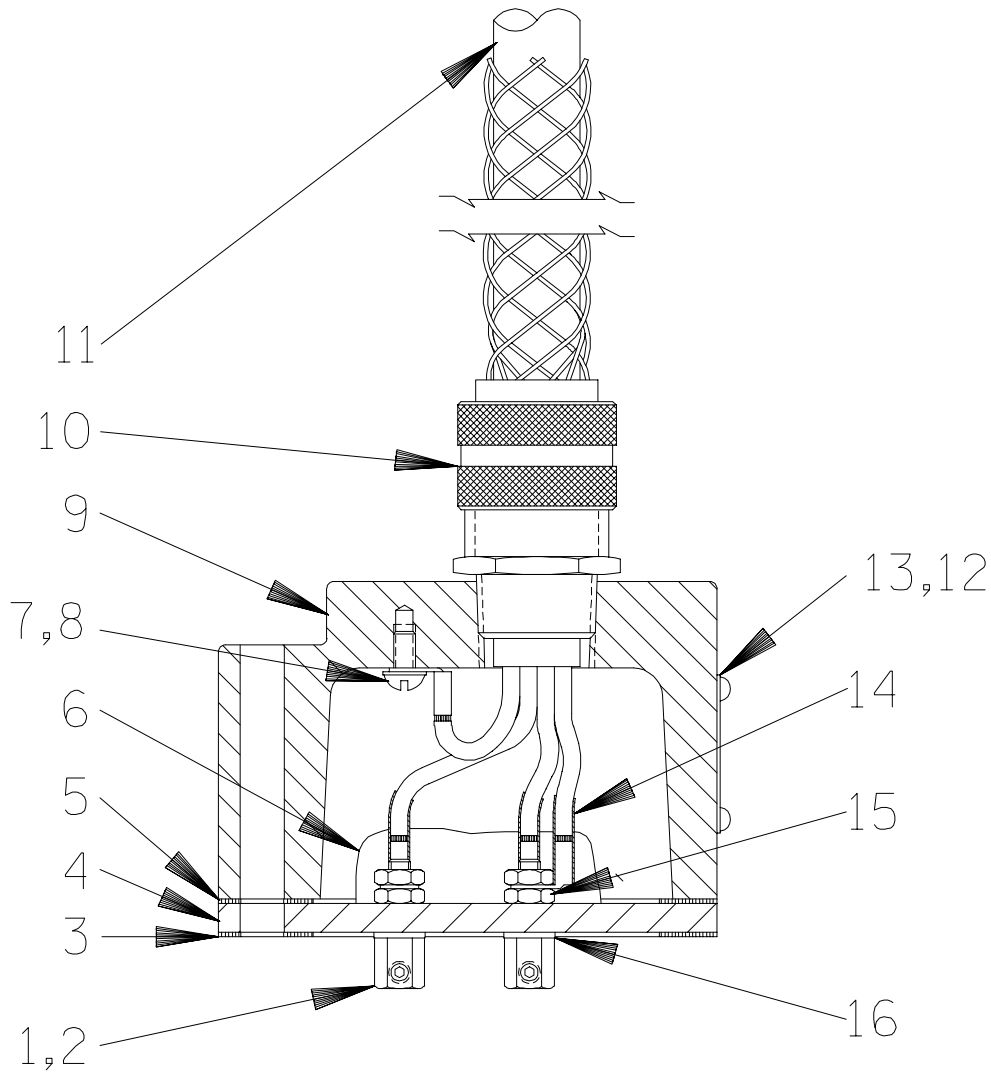

**THE GORMAN-RUPP COMPANY • MANSFIELD, OHIO**

GORMAN-RUPP OF CANADA LIMITED • ST. THOMAS, ONTARIO, CANADA

Printed in U.S.A.

MAY 1, 1997

Rev. B 02/10/06

©Copyright by the Gorman-Rupp Company

5 of 6

Page 150.4 H7

**S/N 1129913 Up  
PUMP ISSUE 1**

**Terminal Housing 47367—053 (575/3)**

If your pump serial number is followed by an "N", your pump is **NOT** a standard production model. Contact the Gorman-Rupp Company to verify part numbers.

ITEM NO.	PART NAME	PART NUMBER	MAT'L CODE	QTY
1	TERMINAL	11181	14100	3
2	ALLEN HD SET SCREW	GA#10—01S	15991	3
3	* GASKET	38687—525	20000	1
4	TERMINAL PLATE	38713—008	23010	1
5	* GASKET	38687—525	20000	1
6	RTV SEALANT	18771—106	---	1
7	RD HD MACH SCREW	X#10—02	15991	1
8	T-TYPE LOCK WASHER	AK#10	15991	1
9	TERMINAL HOUSING	38381—231	13040	1
10	CABLE GRIP	27111—011	---	1
11	* CABLE ASSY	47351—053	---	1
12	INFO PLATE	38816—047	17990	1
13	DRIVE SCREW	BM#04—03	17000	4
14	* HEAT-SHRINK TUBE	31411—233	19530	3
15	HEX NUT	D#10	14990	6
16	* DYNA-SEAL WASHER	S1590	---	3

**OPTIONAL:**

HEAT SHRINK TERMINAL KIT	48315—006	---	1
--------------------------	-----------	-----	---

\* INDICATES PARTS RECOMMENDED FOR STOCK



**For U.S. and International Warranty Information,  
Please Visit [www.grpumps.com/warranty](http://www.grpumps.com/warranty)  
or call:  
U.S.: 419-755-1280  
International: +1-419-755-1352**

**For Canadian Warranty Information,  
Please Visit [www.grcanada.com/warranty](http://www.grcanada.com/warranty)  
or call:  
519-631-2870**