

B 16669

NOTE:
GHS JACKETED BACKHEAD DIMENSIONS ARE THE SAME AS THE STANDARD GHS BACKHEAD.

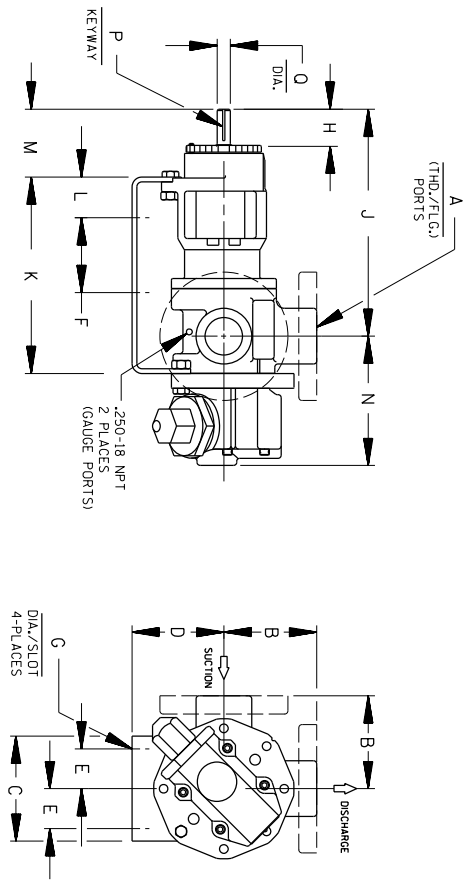

CAD FILE NO.: 16669

MODEL NUMBERS	PUMP DIMENSIONS - INCHES [MILLIMETERS]															
	A	B	C	D	E	F	G	H	J	K	L	M	N	P	Q	
GHS D	1"	2.50* [64]	4.00 [102]	3.50* [89]	1.62 [41]	5.50 [140]	.41 [10]	1.16 [30]	8.43 [214]	7.54 [192]	1.09 [28]	2.29 [58]	4.98 [127]	.75 [19]	.50 [13]	
	1 1/2"	3.75 [95]	4.00 [102]	4.88 [124]	4.50 [114]	8.00 [203]	.41 [10]	1.62 [41]	12.06 [306]	10.72 [272]	1.52 [39]	3.35 [85]	5.70 [145]	1.25 [32]	.75 [19]	
	2"	4.00 [102]	4.00 [102]	4.00 [102]	4.25 [108]	1.62 [41]	5.50 [140]	.41 [10]	1.62 [41]	12.06 [306]	10.72 [272]	1.52 [39]	3.35 [85]	5.70 [145]	1.25 [32]	.75 [19]
GHS G GHA G	1 1/2"	3.50* [89]	4.88 [124]	4.50 [114]	1.62 [41]	8.00 [203]	.41 [10]	1.62 [41]	12.06 [306]	10.72 [272]	1.52 [39]	3.35 [85]	5.70 [145]	1.25 [32]	.75 [19]	
	2"	4.00 [102]	4.00 [102]	4.00 [102]	4.25 [108]	1.62 [41]	5.50 [140]	.41 [10]	1.62 [41]	12.06 [306]	10.72 [272]	1.52 [39]	3.35 [85]	5.70 [145]	1.25 [32]	.75 [19]
	2 1/2"	5.00 [127]	5.00 [127]	5.00 [127]	5.25 [133]	1.62 [41]	8.00 [203]	.41 [10]	1.62 [41]	12.06 [306]	10.72 [272]	1.52 [39]	3.35 [85]	5.70 [145]	1.25 [32]	.75 [19]
GHS J GHA J	2"	4.50* [114]	6.88 [175]	5.25* [133]	2.88 [73]	10.00 [254]	.44 [11]	2.50 [64]	15.68 [398]	14.31 [363]	2.77 [70]	4.48 [114]	8.50 [216]	.25 [6]	1.00 [25]	
	2 1/2"	5.00 [127]	5.00 [127]	5.00 [127]	5.25 [133]	10.00 [254]	.44 [11]	2.50 [64]	15.68 [398]	14.31 [363]	2.77 [70]	4.48 [114]	8.50 [216]	.25 [6]	1.00 [25]	
	3"	6.31 [160]	6.31 [160]	6.31 [160]	6.31 [160]	10.00 [254]	.44 [11]	2.50 [64]	15.68 [398]	14.31 [363]	2.77 [70]	4.48 [114]	8.50 [216]	.25 [6]	1.00 [25]	
GHS N GHA N	1 1/2"	5.12* [130]	8.00 [203]	4.50 [114]	2.88 [73]	10.00 [254]	.44 [11]	2.50 [64]	16.37 [416]	15.14 [385]	2.69 [68]	4.56 [116]	7.59 [193]	.25 [6]	1.12 [28]	
	2"	5.25 [133]	8.00 [203]	5.25 [133]	2.88 [73]	10.00 [254]	.44 [11]	2.50 [64]	16.37 [416]	15.14 [385]	2.69 [68]	4.56 [116]	7.59 [193]	.25 [6]	1.12 [28]	
	3"	7.19 [185]	7.19 [185]	7.19 [185]	7.00 [178]	10.00 [254]	.44 [11]	2.50 [64]	16.37 [416]	15.14 [385]	2.69 [68]	4.56 [116]	7.59 [193]	.25 [6]	1.12 [28]	
GHS R GHA R	2"	6.50* [165]	10.50 [267]	7.00 [178]	3.75 [95]	13.75 [349]	.52 [13]	2.25 [57]	17.87 [454]	17.36 [441]	1.86 [47]	4.70 [119]	11.31 [287]	.38 [10]	1.44 [37]	
	2 1/2"	7.19 [185]	10.50 [267]	7.00 [178]	3.75 [95]	13.75 [349]	.52 [13]	2.25 [57]	17.87 [454]	17.36 [441]	1.86 [47]	4.70 [119]	11.31 [287]	.38 [10]	1.44 [37]	
	4"	7.19 [185]	10.50 [267]	7.00 [178]	3.75 [95]	13.75 [349]	.52 [13]	2.25 [57]	17.87 [454]	17.36 [441]	1.86 [47]	4.70 [119]	11.31 [287]	.38 [10]	1.44 [37]	

H PORTS ARE COMPATIBLE WITH 125" OR 250" ANSICAST IRON FLANGES. ALL OTHER PORTS ARE TAPPED NPT FOR ANSIPPEL OPTIONAL JOIN FLANGES OR TAPPED (BSP) PORTS AVAILABLE FOR EXPORT MARKET. * STANDARD DIMENSION † 180° HOUSING

- DO NOT SCALE DRAWING.
- GRAPHICS ARE NOT TO SCALE.
- PUMP GRAPHICS ARE BASED ON A "G" SIZE PUMP.

GHS, SEC. 545: PAGE 15
JUNE 2009

CLOCKWISE ROTATION
(FROM SHAFT END)

THE GORMAN-RUPP CO.
MANSFIELD, OHIO ST. THOMAS, ONTARIO

DRAWN BY	SAR	SCALE	NONE	MODEL	GHS\GHA 90°
DATE	5-11-00	REVISED	10-09-17	OUTLINE NUMBER	16669

DIMENSIONS:
INCHES
[MILLIMETERS]