

Use With: OM-04402
MR-04821

PUBLICATION NUMBER
PL-04642-03
January 14, 1998



**PRIME-AIRETM SERIES
PUMP MODEL
PA6A60-4045D**

**MANUAL
PART 2 of 3**

**PARTS
LIST
WITH
PERFORMANCE CURVE**

THE GORMAN-RUPP COMPANY • MANSFIELD, OHIO

GORMAN-RUPP OF CANADA LIMITED • ST. THOMAS, ONTARIO, CANADA Printed in U.S.A.

©Copyright by the Gorman-Rupp Company



The engine exhaust from this product contains chemicals known to the State of California to cause cancer, birth defects or other reproductive harm.

PERFORMANCE CURVE – SECTION A

RECORDING MODEL AND SERIAL NUMBERS

Please record the pump model and serial number in the spaces provided below and in the separate Installation/Operation Manual accompanying your pump. Your Gorman-Rupp distributor needs this information when you require parts or service.

Pump Model: _____

Serial Number: _____

WARRANTY INFORMATION

The pump warranty is provided as part of Gorman-Rupp's support program for customers who operate and maintain their equipment as described in this manual and other accompanying literature. Please note that should the equipment be abused or modified to change its performance beyond the original factory specifications, the warranty will become void and any claim will be denied.

PERFORMANCE CURVE

The performance curve on the following page is based on 70° F (21° C) clear water at sea level, corrected to 0.80 specific gravity, with minimum suction lift. Since pump installations are seldom identical, your performance may be different due to such factors as viscosity, specific gravity, elevation, temperature, and impeller trim.

If your pump serial number is followed by an "N", your pump is **NOT** a standard production model. Contact the Gorman-Rupp Company to verify performance or part numbers.



Pump speed and operating condition points must be within the continuous performance range shown on the curve.

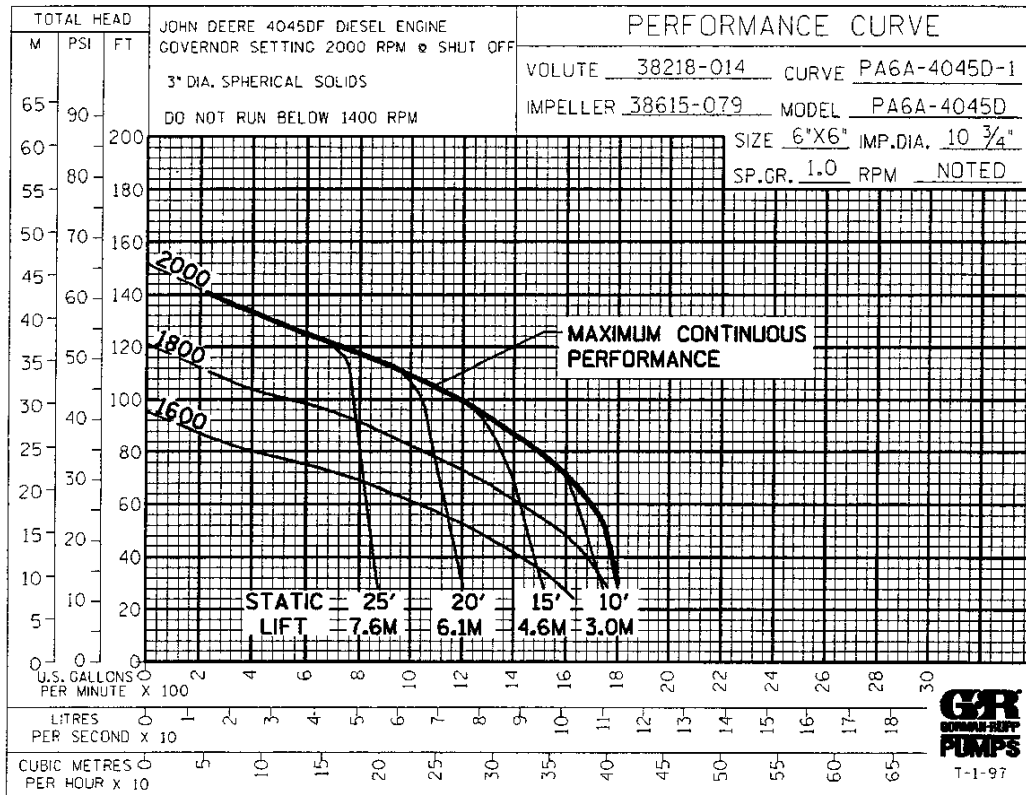

Performance Curve – Model PA6A60-4045D

This Page Intentionally Blank

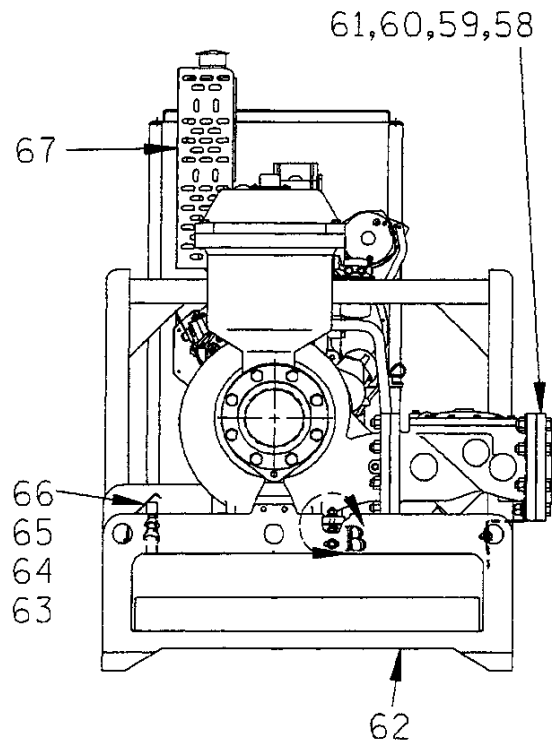
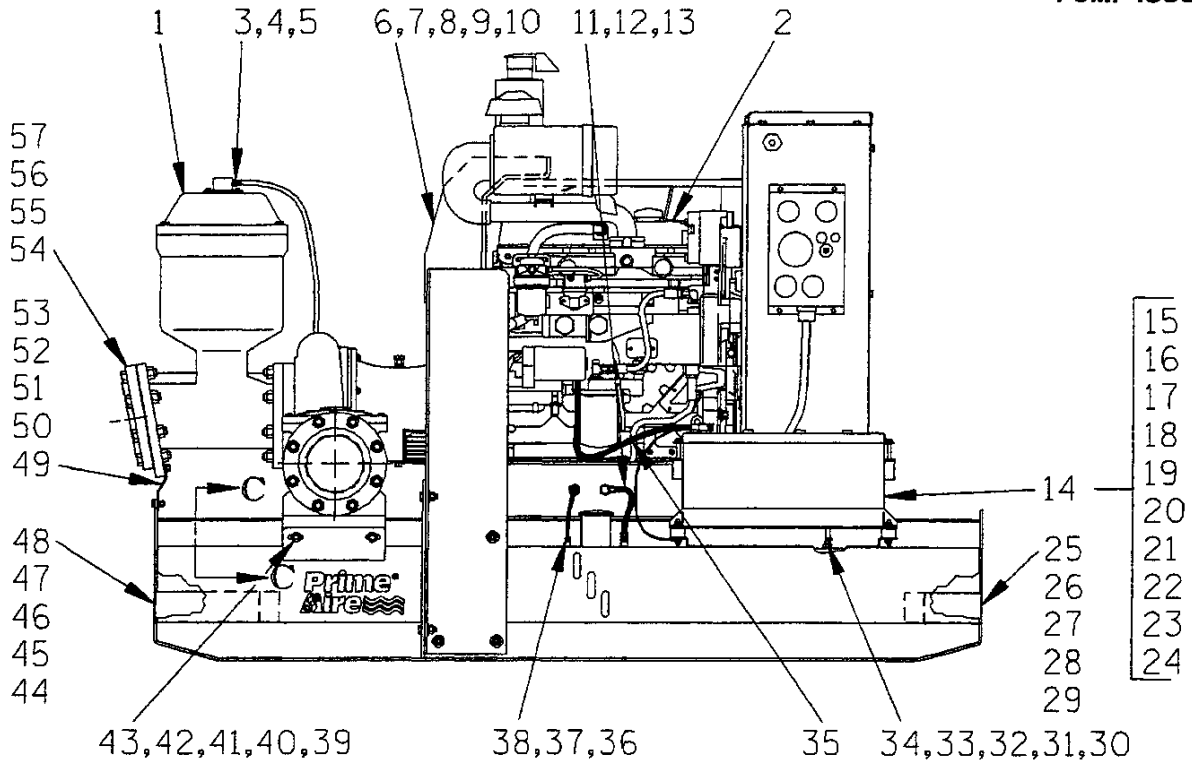

THE GORMAN-RUPP COMPANY • MANSFIELD, OHIO

GORMAN-RUPP OF CANADA LIMITED • ST. THOMAS, ONTARIO, CANADA

Printed in U.S.A.

S/N 1142395 Up
PUMP ISSUE 3

PARTS LIST
Pump Model PA6A60-4045D

If your pump serial number is followed by an "N", your pump is NOT a standard production model. Contact the Gorman-Rupp Company to verify part numbers.

ITEM NO.	PART NAME	PART NUMBER	MAT'L CODE	QTY	ITEM NO.	PART NAME	PART NUMBER	MAT'L CODE	QTY
1	PUMP ASSEMBLY	PA6A60-(SAE 4/10)		1	35	I/O CABLE ASSY	47311-107	---	1
2	J D 4045DF150 ENGINE	29224-113	---	1	36	HOSE BARB FITTING	26523-386	---	2
3	REDUCER BUSHING	AP1608	11999	1	37	HOSE	11308H	---	1
4	MALE CONNECTOR	26525-020	---	2	38	HOSE CLAMP	26518-641	---	2
5	1/2" BRAIDED HOSE (3.25')	18513-113	---	1	39	CHECK VALVE BRKT	34518-017	15120	1
6	LIFTING BAIL	44711-020	24150	1	40	HEX HD CAPSCREW	B0604	15991	2
7	HEX HD CAPSCREW	B0805	15991	10	41	HEX NUT	D06	15991	2
8	HEX NUT	D08	15991	6	42	LOCKWASHER	J06	15991	2
9	LOCKWASHER	J08	15991	10	43	FLAT WASHER	K06	15991	4
10	FLAT WASHER	K08	15991	12	44	FUEL TANK RETAINER	41441-408	24150	1
11	MALE CONNECTOR	S1447	---	1	45	CARRIAGE BOLT	AB0805	15991	2
12	MALE ELBOW	26351-131	---	1	46	HEX NUT	D08	15991	2
13	HOSE ASSY	46341-789	---	1	47	LOCKWASHER	J08	15991	2
14	BATTERY BOX ASSY	GRP40-08C	---	1	48	FLAT WASHER	K08	15991	2
15	-HEX HD CAPSCREW	B0607	15991	2	49	PRIM CHAMBER BRKT	34535-010	15120	1
16	-FLAT WASHER	K06	15991	2	50	HEX HD CAPSCREW	B0604	15991	3
17	-FLANGED HEX NUT	21765-314	---	2	51	HEX NUT	D06	15991	2
18	-GRND CABLE ASSY	47311-064	---	1	52	LOCKWASHER	J06	15991	3
19	-BATTERY BOX LID	42113-012	24150	1	53	FLAT WASHER	K06	15991	3
20	-12V BATTERY	SEE OPTIONS LIST			54	SUCTION FLANGE	1758	10010	1
21	-BATTERY TAG	38818-506	---	1	55	SUCT FLANGE GSKT	1679G	18000	1
22	-BATTERY BOX	42431-030	24150	1	56	HEX HD CAPSCREW	B1212	15991	8
23	-STUD MOUNT	24631-006	---	4	57	HEX NUT	D12	15991	8
24	-FLANGED HEX NUT	21765-314	---	8	58	DISCHARGE FLANGE	1758	10010	1
25	A/C FUEL TANK RETAINER	41441-407	24150	1	59	DISCH FLANGE GSKT	1679G	18000	1
26	CARRIAGE BOLT	AB0805	15991	2	60	HEX HD CAPSCREW	B1213	15991	6
27	HEX NUT	D08	15991	2	61	HEX NUT	D12	15991	6
28	LOCKWASHER	J08	15991	2	62	SKID ASSY	41565-570	24150	1
29	FLAT WASHER	K08	15991	2	63	VENTURI GUARD ASSY	42381-067	---	1
30	BARB ELBOW	26523-386	---	1	64	HEX HD CAPSCREW	B0504	15991	2
31	HOSE CLAMP	26518-641	---	1	65	LOCKWASHER	J05	15991	2
32	PLASTIC TUBING, 2.5'	18523-366	---	1	66	FLAT WASHER	K05	15991	2
33	PIPE NIPPLE	T0406	15079	1	67	MUFFLER GRD ASSY	42331-057	---	1
34	PIPE ELBOW	R04	11999	1					

* INDICATES PARTS RECOMMENDED FOR STOCK

Above Serial Numbers Do Not Apply To Pumps Made In Canada.

CANADIAN SERIAL NO. AND UP

THE GORMAN-RUPP COMPANY • MANSFIELD, OHIO

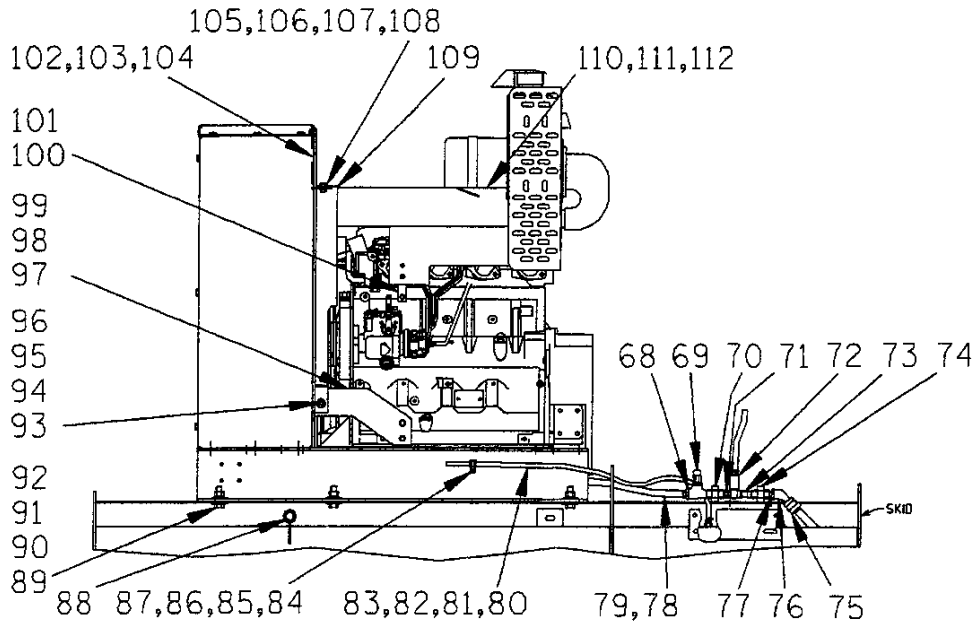

VIEW A-A
VENTURI SYSTEM AND BELT GUARDS

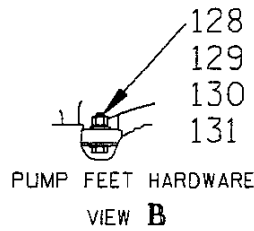
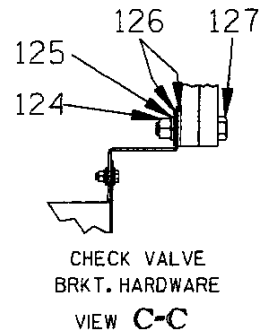
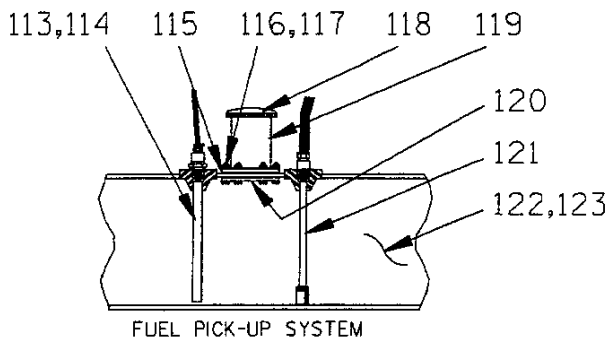

THE GORMAN-RUPP COMPANY • MANSFIELD, OHIO

GORMAN-RUPP OF CANADA LIMITED • ST. THOMAS, ONTARIO, CANADA

Printed in U.S.A.

S/N 1142395 Up
PUMP ISSUE 3

PARTS LIST
Pump Model PA6A60-4045D

ITEM NO.	PART NAME	PART NUMBER	MAT'L CODE	QTY	ITEM NO.	PART NAME	PART NUMBER	MAT'L CODE	QTY
68	SERVICE TEE	US08	11999	1	112	LOCKWASHER	J06	15991	2
69	RELIEF VALVE	26662-028	---	1	113	FUEL RETURN ASSY	46331-015	24150	1
70	PIPE UNION	AH08	11999	1	114	PIPE COUPLING	AE04	15079	1
71	REDUCER BUSHING	AP0808	15079	1	115	FILLER NECK GASKET	29332-161	---	1
72	PIPE COUPLING	AE08	15079	1	116	NYLOCK LOCKNUT	BC#10	15991	6
73	VENTURI	26817-002	---	1	117	SEALING WASHER	25123-056	---	6
74	PIPE UNION	AH08	11999	1	118	FILL CAP	29332-108	---	1
75	RED PIPE BUSHING	AE1208	15079	1	119	FILLER NECK	29332-152	---	1
76	45° STREET ELBOW	AGS08	11999	1	120	BACK-UP RING ASSY	46523-003	24170	1
77	PIPE NIPPLE	T08	15079	1	121	FUEL PICK-UP	29332-143	---	1
78	HOSE ASSY	46341-422	---	1	122	FUEL TANK ASSY	46711-074	---	1
79	MALE ADAPTER	26351-065	---	2	123	PIPE PLUG	P06	19220	1
80	REDUCER BUSHING	AP0604	15079	1	124	HEX NUT	D12	15991	2
81	MALE CONNECTOR	26523-386	---	1	125	LOCK WASHER	J12	15991	2
82	HOSE CLAMP	26518-641	---	1	126	FLAT WASHER	K12	15991	4
83	2 1/2' PLASTIC TUBING	18523-366	---	1	127	HEX HD CAPSCREW	B1214	15991	2
84	HEX HD CAPSCREW	B#10-03	15991	2	128	HEX HD CAPSCREW	B0808	15991	2
85	HEX NUT	D#10	15991	2	129	FLAT WASHER	K08	15991	4
86	LOCKWASHER	J#10	15991	2	130	LOCK WASHER	J08	15991	2
87	CUSHION CABLE CLAMP	27111-339	---	2	131	HEX NUT	D08	15991	2
88	OIL DRAIN ASSY	46342-013	---	1					
89	HEX HD CAPSCREW	B1007	15991	6		NOT SHOWN:			
90	HEX NUT	D10	15991	6		INSTRUCTION DECAL	38818-128	---	1
91	LOCKWASHER	J10	15991	6		WARNING DECAL	38816-063	---	1
92	FLAT WASHER	K10	15991	12		LUBE DECAL	38816-079	---	1
93	HEX HD CAPSCREW	B0604	15991	1		WARNING DECAL	38816-096	---	1
94	HEX NUT	D06	15991	1		SUCTION STICKER	6588AG	---	1
95	LOCKWASHER	J06	15991	1		DISCHARGE STICKER	6588BJ	---	1
96	FLAT WASHER	K06	15991	2		RPM DECAL	2613FJ	---	1
97	BELT GUARD ASSY	33441-004	15120	1		LIFT DECAL	38816-175	---	1
98	HEX HD CAPSCREW	22645-180	---	2		LIFT DECAL	38816-218	---	2
99	LOCKWASHER	21171-512	---	2		PA DECAL	38812-078	---	2
100	GUARD BRKT ASSY	42381-071	24150	1		WARNING DECAL	2613FE	---	1
101	HEX HD CAPSCREW	22645-158	---	1		ROTATION STICKER	2613M	---	1
102	HEX HD CAPSCREW	B0603	15991	1		G-R DECAL	GR06	---	2
103	LOCKWASHER	J06	15991	1		INSTR TAG PAPER	38817-009	---	1
104	GUARD BRKT ASSY	42381-072	24150	1		ENG START-UP TAG	38816-269	---	1
105	HEX HD CAPSCREW	B0604	15991	2		NAME PLATE	38818-127	13000	1
106	HEX NUT	D06	15991	2		DRIVE SCREW	BM#04-03	17000	4
107	LOCKWASHER	J06	15991	2		STRAINER	7823A	24000	1
108	FLAT WASHER	K06	15991	2					
109	BELT GUARD	34778-007	15120	1		OPTIONAL:			
110	ENG GUARD ASSY	42381-070	24150	1		12V BATTERY	29331-506	---	1
111	HEX HD CAPSCREW	B0603	15991	2					

* INDICATES PARTS RECOMMENDED FOR STOCK

THE GORMAN-RUPP COMPANY • MANSFIELD, OHIO

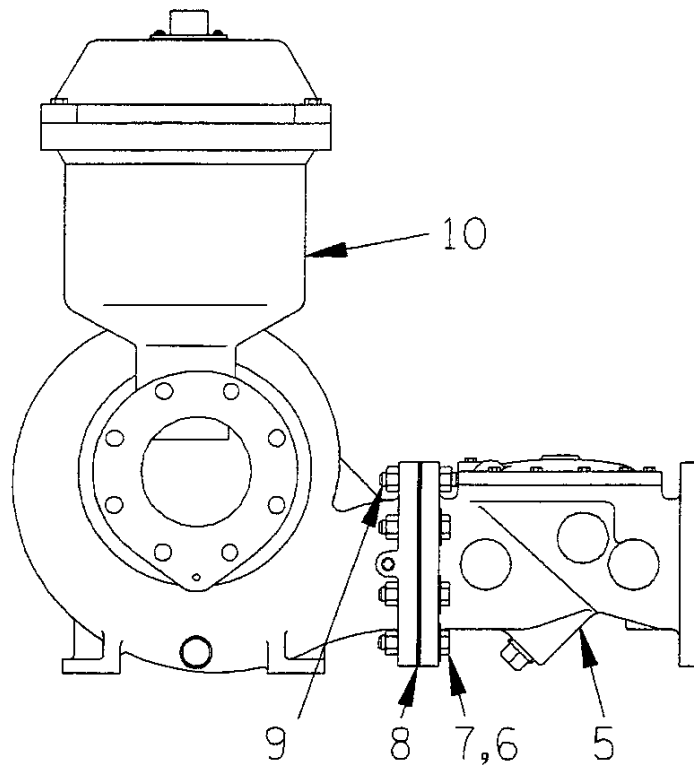
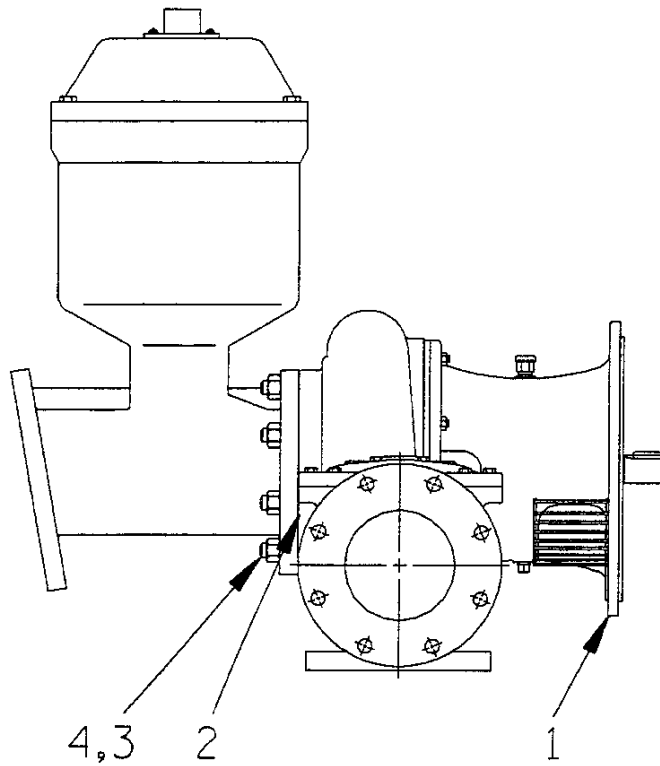

THE GORMAN-RUPP COMPANY • MANSFIELD, OHIO

GORMAN-RUPP OF CANADA LIMITED • ST. THOMAS, ONTARIO, CANADA

Printed in U.S.A.

S/N 1142395 Up
PUMP ISSUE 3

PARTS LIST
PA6A60-(SAE 4/10) Pump Assembly

ITEM NO.	PART NAME	PART NUMBER	MAT'L CODE	QTY
1	PUMP END ASSY	66E60-(SAE4/10)	---	1
2	* PUMP CASING GSKT	1679G	18000	1
3	STUD	C1211	15991	8
4	HEX NUT	D12	15991	8
5	CHECK VALVE ASSY	26642-126	---	1
	-FLAPPER	26688-001	---	1
	-COVER GASKET	26688-002	---	1
6	HEX HD CAPSCREW	B1214	15991	7
7	HEX NUT	D12	15991	9
8	* GASKET 6 IN.	25113-036	---	1
9	STUD	C1215	15991	1
10	PRIMING CHAMBER ASSY	46112-703	---	1

* INDICATES PARTS RECOMMENDED FOR STOCK

THE GORMAN-RUPP COMPANY • MANSFIELD, OHIO

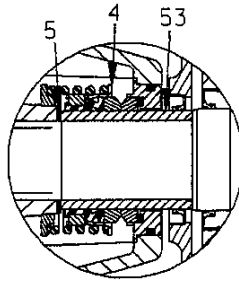

SEAL AREA DETAIL

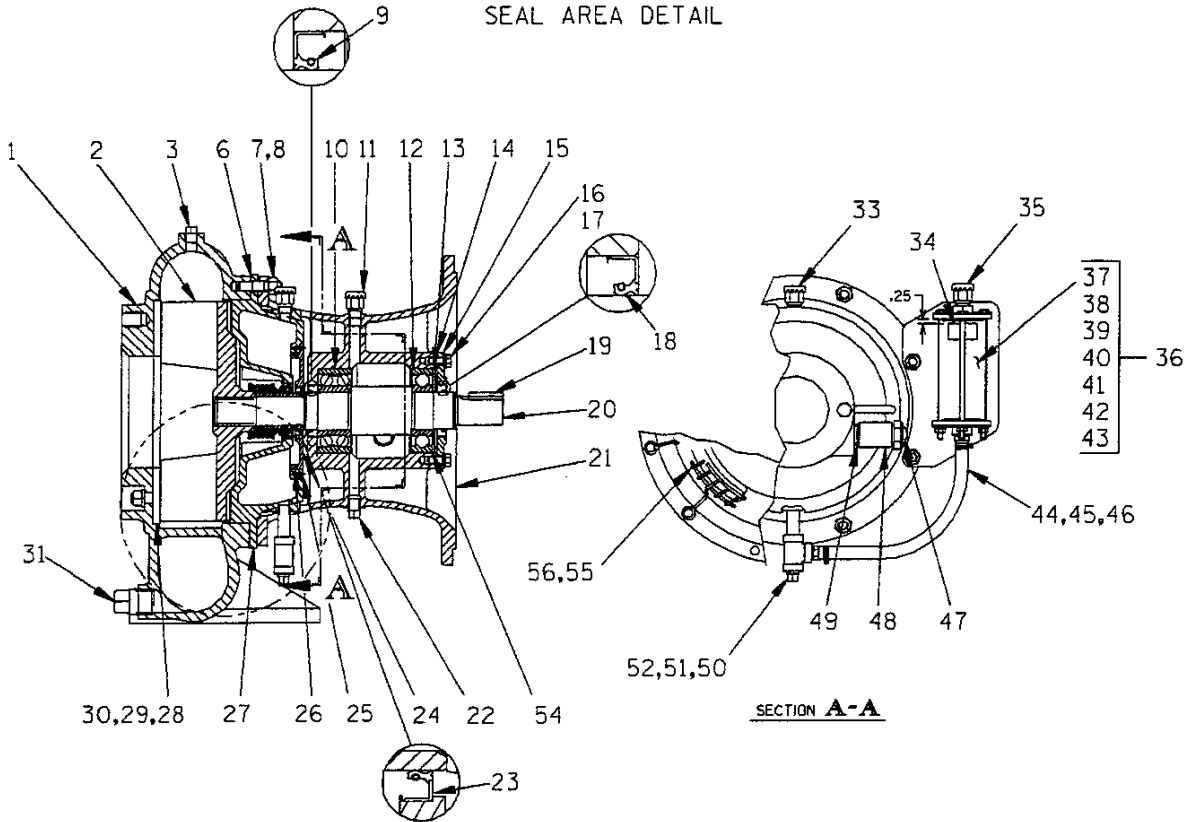

SECTION A-A

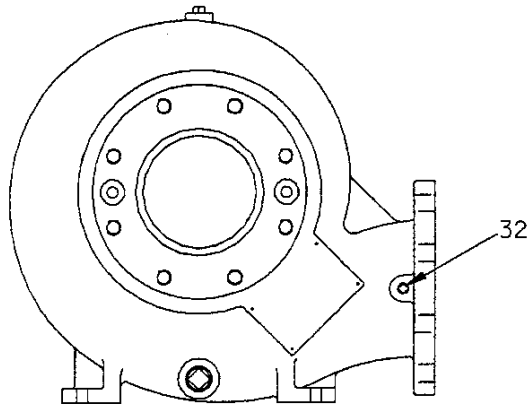

PUMP CASING FRONT VIEW

THE GORMAN-RUPP COMPANY • MANSFIELD, OHIO

GORMAN-RUPP OF CANADA LIMITED • ST. THOMAS, ONTARIO, CANADA

Printed in U.S.A.

S/N 1142395 Up
PUMP ISSUE 3

PARTS LIST
66E60-(SAE4/10) Pump End Assembly

ITEM NO.	PART NAME	PART NUMBER	MAT'L CODE	QTY	ITEM NO.	PART NAME	PART NUMBER	MAT'L CODE	QTY
1	PUMP CASING	38218-014	10000	1	29	HEX NUT	D08	15991	2
2 *	IMPELLER ASSY	46151-409	---	1	30	LOCKWASHER	J08	15991	2
	-SPRING RETAINER	31167-023	15000	1	31	PIPE PLUG	P16	10009	1
3	PIPE PLUG	P06	15079	1	32	PIPE PLUG	P04	15079	1
4 *	SEAL ASSY	46512-048	---	1	33	AIR VENT	S1703	---	1
5 *	ADJ SHIM SET	5091	17090	1	34	OIL LEVEL DECAL	38816-123	---	1
6 *	CASING GASKET SET	34G	18000	1	35	AIR VENT	S1703	---	1
7	STUD	C0809	15991	8	36	SIGHT GAUGE ASSY	46353-045	---	1
8	HEX NUT	D08	15991	8	37	-LOWER COVER	26846-501	---	2
9 *	OIL SEAL	25258-622	---	1	38	-SUPPORT ASSY	41881-555	24150	1
10 *	INBOARD BALL BEARING	23421-461	---	1	39	-HEX HD CAPSCREW	B0426	15991	3
11	AIR VENT	S1703	---	1	40	-HEX NUT	D04	15991	3
12 *	OUTBOARD BALL BRG	S1077	---	1	41	-LOCKWASHER	J04	15991	3
13 *	THRUST WASHER	31133-197	15210	1	42 *	-CHAMBER GSKT	38681-204	20000	2
14 *	BRG COVER GSKT	5413G	18000	1	43	-SIGHT CHAMBER	26846-502	---	1
15	BEARING CAP	4185A	10010	1	44	MALE CONNECTOR	26523-409	---	2
16	HEX HD CAPSCREW	B0604	15991	4	45	HOSE	18513-054	---	1
17	LOCKWASHER	J06	15991	4	46	HOSE CLAMP	26518-642	---	2
18 *	OIL SEAL	25258-622	---	1	47	OIL LVL SIGHT GAUGE	S1471	---	1
19 *	IMP SHAFT KEY	N0607	15990	1	48	PIPE COUPLING	AE12	15079	1
20 *	IMPELLER SHAFT	38514-807	1706H	1	49	PIPE NIPPLE	T12	15079	1
21	INTERMEDIATE	38263-614	10010	1	50	PIPE NIPPLE	T0608	15079	1
22	BRG CAV DRAIN PLUG	P06	15079	1	51	PIPE TEE	U06	11999	1
23 *	OIL SEAL	25258-620	---	1	52	SEAL CVTY DRAIN PLUG	P06	15079	1
24	SEAL PLATE COVER	38242-707	10000	1	53 *	SHAFT SLEEVE	31163-016	1706H	1
25	FH MACHINE SCREW	Y#10-02	15991	4	54 *	BRG SHIM SET	8546	15990	1
26 *	SEAL PLT CVR O-RING	25152-256	---	1	55	INTERMEDIATE GUARD	42381-031	24150	1
27	SEAL PLATE	38272-527	10000	1	56	INTERMEDIATE GUARD	42381-032	24150	1
28 *	WEAR PLATE ASSY	46451-746	24150	1	NOT SHOWN:				
						DRIVE ASSY	44162-119	---	1

* INDICATES PARTS RECOMMENDED FOR STOCK

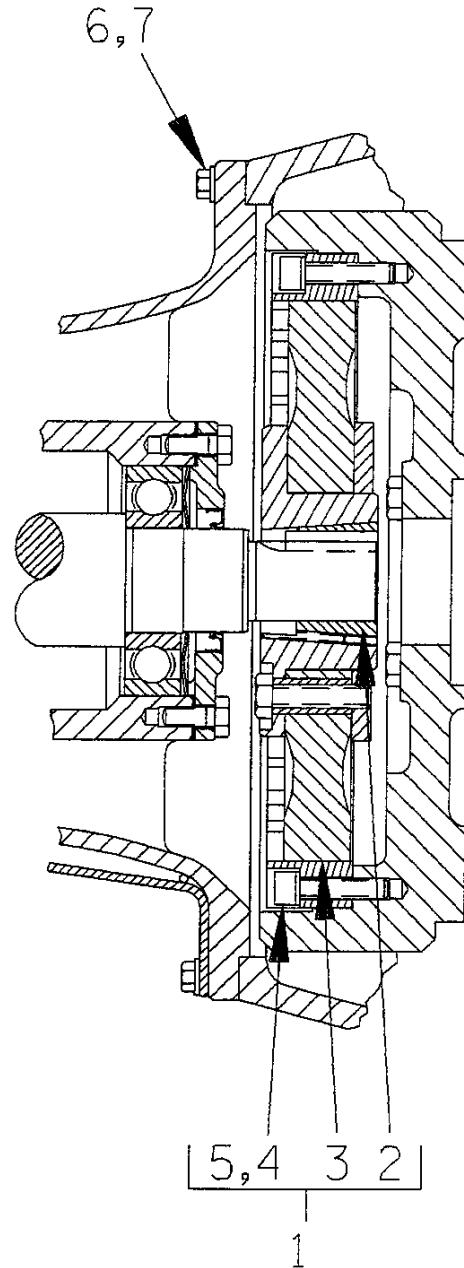

S/N 1142395 Up
PUMP ISSUE 3

PARTS LIST
(SAE4/10) Drive Assembly

ITEM NO.	PART NAME	PART NUMBER	MAT'L CODE	QTY
1	COUPLING KIT	48112-001	-----	1
2	-BUSHING	24131-345	-----	1
3	-COUPLING ASSEMBLY	44165-011	-----	1
4	-LOCKWASHER	21171-536	-----	8
5	-SOCKET HD CAPSCREW	22644-220	-----	8
6	HEX HD CAPSCREW	22645-164	-----	12
7	LOCKWASHER	21171-511	-----	12

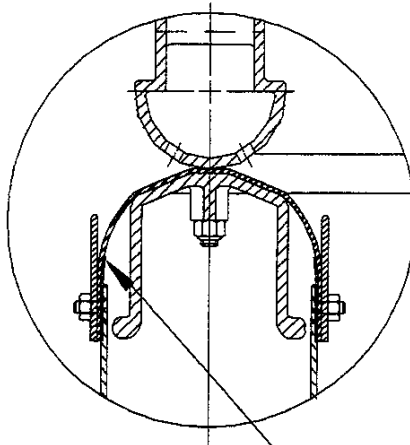

34
VALVE DETAIL

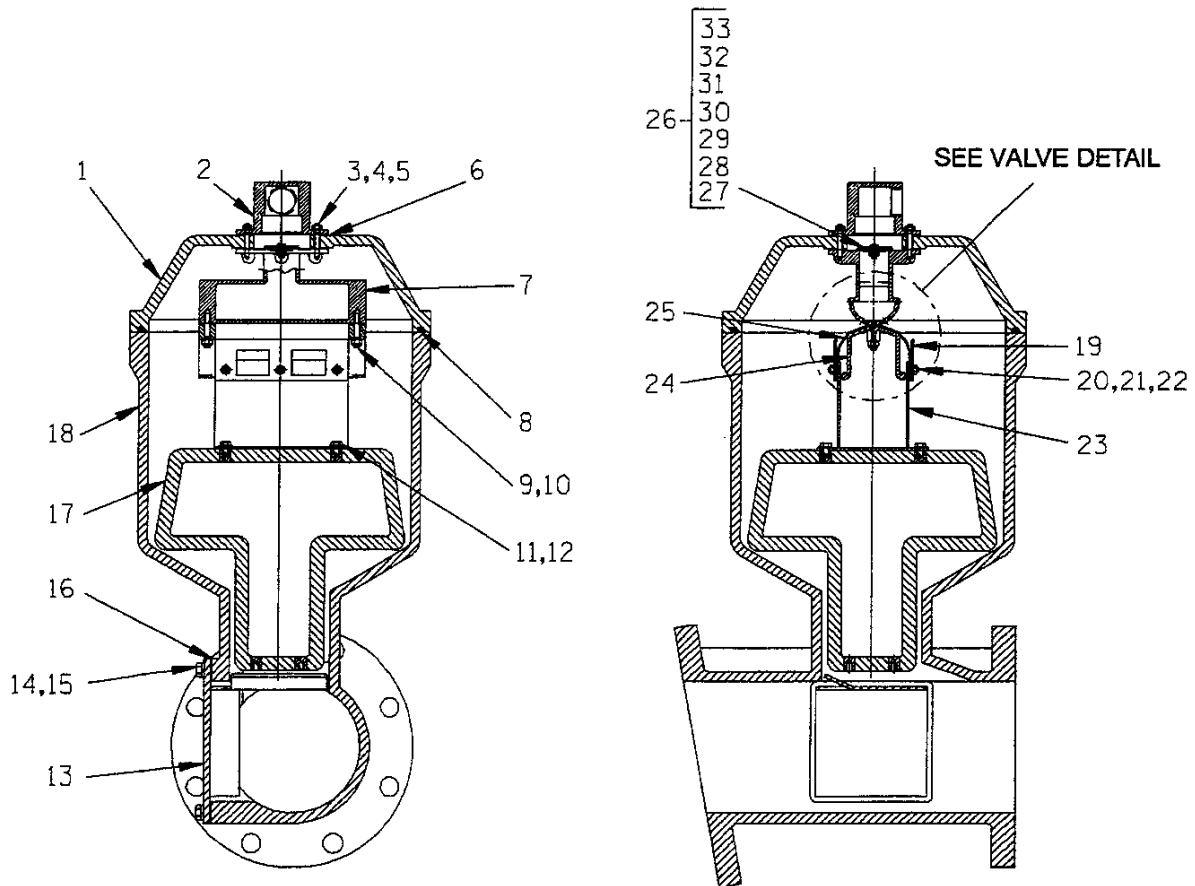

THE GORMAN-RUPP COMPANY • MANSFIELD, OHIO

GORMAN-RUPP OF CANADA LIMITED • ST. THOMAS, ONTARIO, CANADA

Printed in U.S.A.

S/N 1142395 Up
PUMP ISSUE 3

PARTS LIST
46112-703 Peeler Type Priming Valve

ITEM NO.	PART NAME	PART NUMBER	MAT'L CODE	QTY	ITEM NO.	PART NAME	PART NUMBER	MAT'L CODE	QTY
1	PRIMING CHAMBER LID	38346-613	13000	1	20	FLAT HD CAPSCREW	F#10-03	17000	6
2	PEELER VALVE NECK	38349-410	10000	1	21	LOCKWASHER	J#10	17000	6
3	LOCKWASHER	J#10	17000	4	22	HEX NUT	D#10	17000	6
4	HEX NUT	D#10	17000	4	23	VLV STRAP BRKT ASSY	41881-523	2415X	1
5	STUD	21332-038	---	4	24	CLAMP PLATE	38349-406	14000	1
6 *	NECK GASKET	38683-266	19020	1	25	VALVE STRAP	33276-041	19000	1
7	VALVE BODY	38343-014	14000	1	26	CHECK VALVE ASSY	46411-112	---	1
8 *	GASKET STRIP 4.06' LG	18515-031	---	1	27 *	-CHECK VALVE	38671-413	19020	1
9	STUD	C0406 1/2	17000	2	28	-LOCKWASHER	J#10	17000	1
10	HEX LOCK NUT	BC04	17000	2	29	-HEX NUT	D#10	17000	1
11	HEX HD CAPSCREW	B0403	17000	4	30	-FLATWASHER	21161-810	---	1
12	LOCKWASHER	J04	17000	4	31	-HEX HD CAPSCREW	B#10-02	17000	1
13	INDUCTOR GUARD ASSY	42381-066	24150	1	32	-FLATWASHER	21161-811	---	1
14	HEX HD CAPSCREW	B0605	15991	4	33	-SEALING WASHER	S1590	---	1
15	LOCKWASHER	J06	15991	4	34	VLV STRAP PROTECTOR	33271-019	19000	2
16 *	CHAMBER GSKT	38687-552	18000	1	NOT SHOWN:				
17 *	PRIMING VALVE FLOAT	38349-404	19220	1		HEX HD CAPSCREW	B0807	15991	4
18	PRIMING CHAMBER	38343-017	10000	1		PIPE PLUG	P04	15079	1
19	GUIDE PLATE	33522-009	17000	2					

* INDICATES PARTS RECOMMENDED FOR STOCK

**For U.S. and International Warranty Information,
Please Visit www.grpumps.com/warranty**

or call:

U.S.: 419-755-1280

International: +1-419-755-1352

**For Canadian Warranty Information,
Please Visit www.grcanada.com/warranty**

or call:

519-631-2870

THE GORMAN-RUPP COMPANY • MANSFIELD, OHIO

GORMAN-RUPP OF CANADA LIMITED • ST. THOMAS, ONTARIO, CANADA