



PRIME-AIRE[®] SERIES
PUMP MODEL
PA6A60-4045D

MANUAL
PART 2 of 3

PARTS
LIST
WITH
PERFORMANCE CURVE

THE GORMAN-RUPP COMPANY • MANSFIELD, OHIO

www.grpumps.com

GORMAN-RUPP OF CANADA LIMITED • ST. THOMAS, ONTARIO, CANADA Printed in U.S.A.

©Copyright by the Gorman-Rupp Company

Register your new
Gorman-Rupp pump online at
www.grpumps.com

Valid serial number and e-mail address required.



The engine exhaust from this product contains chemicals known to the State of California to cause cancer, birth defects or other reproductive harm.

RECORD YOUR PUMP MODEL AND SERIAL NUMBER

Please record your pump model and serial number in the spaces provided below. Your Gorman-Rupp distributor needs this information when you require parts or service.

Pump Model: _____

Serial Number: _____

PERFORMANCE CURVE – SECTION A

RECORDING MODEL AND SERIAL NUMBERS

Please record the pump model and serial number in the spaces provided below and in the separate Installation/Operation Manual accompanying your pump. Your Gorman-Rupp distributor needs this information when you require parts or service.

Pump Model: _____

Serial Number: _____

WARRANTY INFORMATION

The pump warranty is provided as part of Gorman-Rupp's support program for customers who operate and maintain their equipment as described in this manual and other accompanying literature. Please note that should the equipment be abused or modified to change its performance beyond the original factory specifications, the warranty will become void and any claim will be denied.

PERFORMANCE CURVE

The performance curve on the following page is based on 70° F (21° C) clear water at sea level, corrected to 0.80 specific gravity, with minimum suction lift. Since pump installations are seldom identical, your performance may be different due to such factors as viscosity, specific gravity, elevation, temperature, and impeller trim.

If your pump serial number is followed by an "N", your pump is **NOT** a standard production model. Contact the Gorman-Rupp Company to verify performance or part numbers.



Pump speed and operating condition points must be within the continuous performance range shown on the curve.

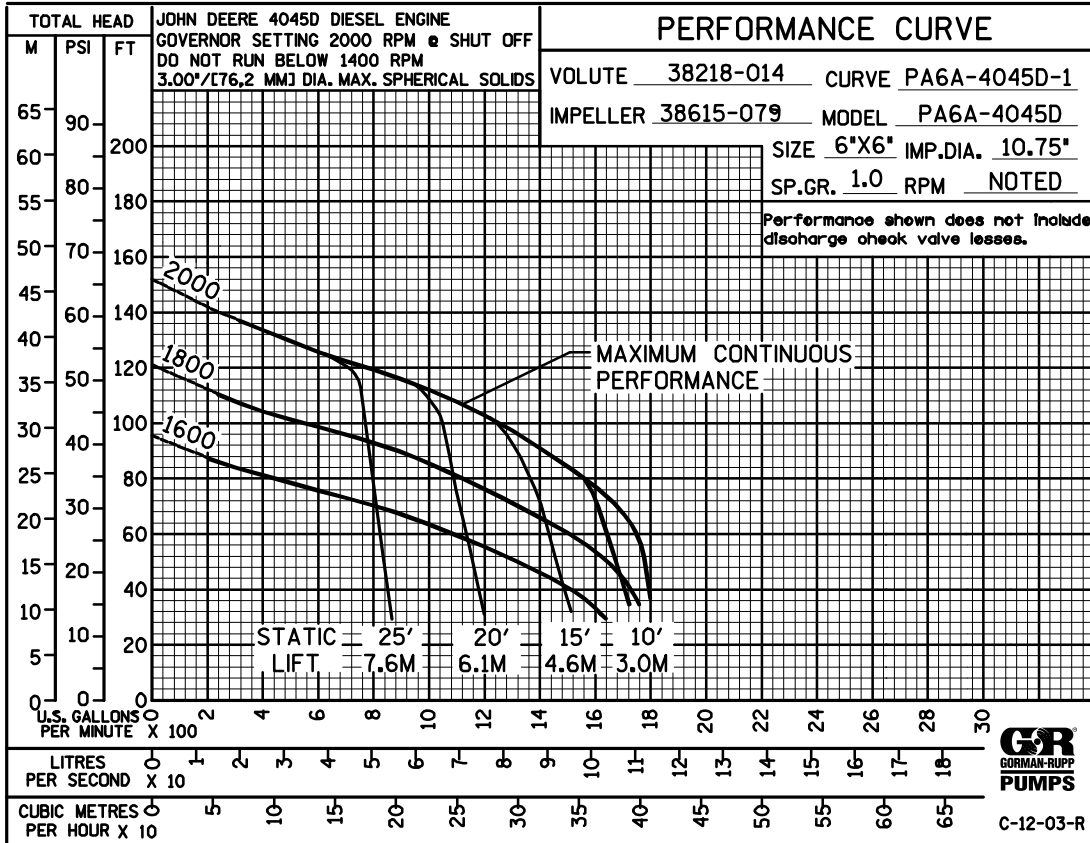

Performance Curve – Model PA6A60-4045D

This Page Intentionally Blank

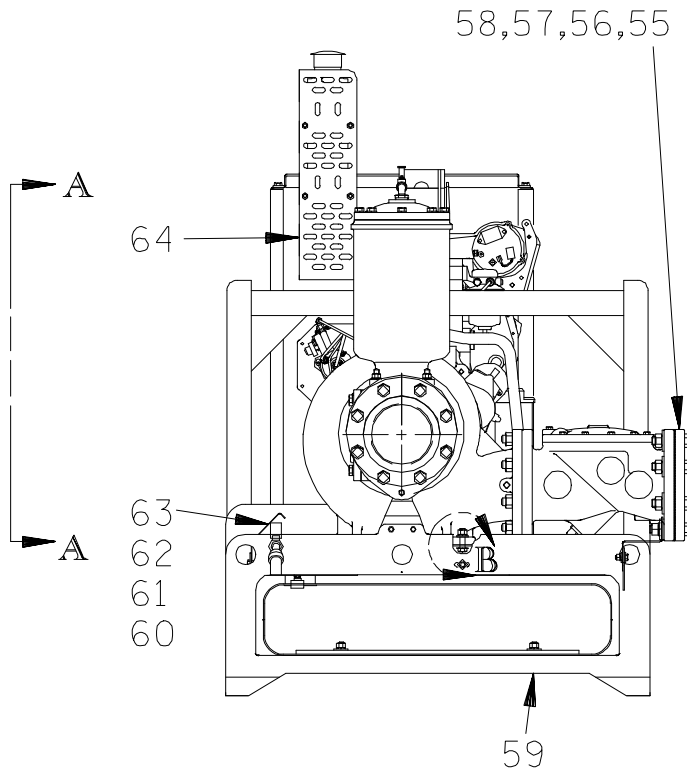
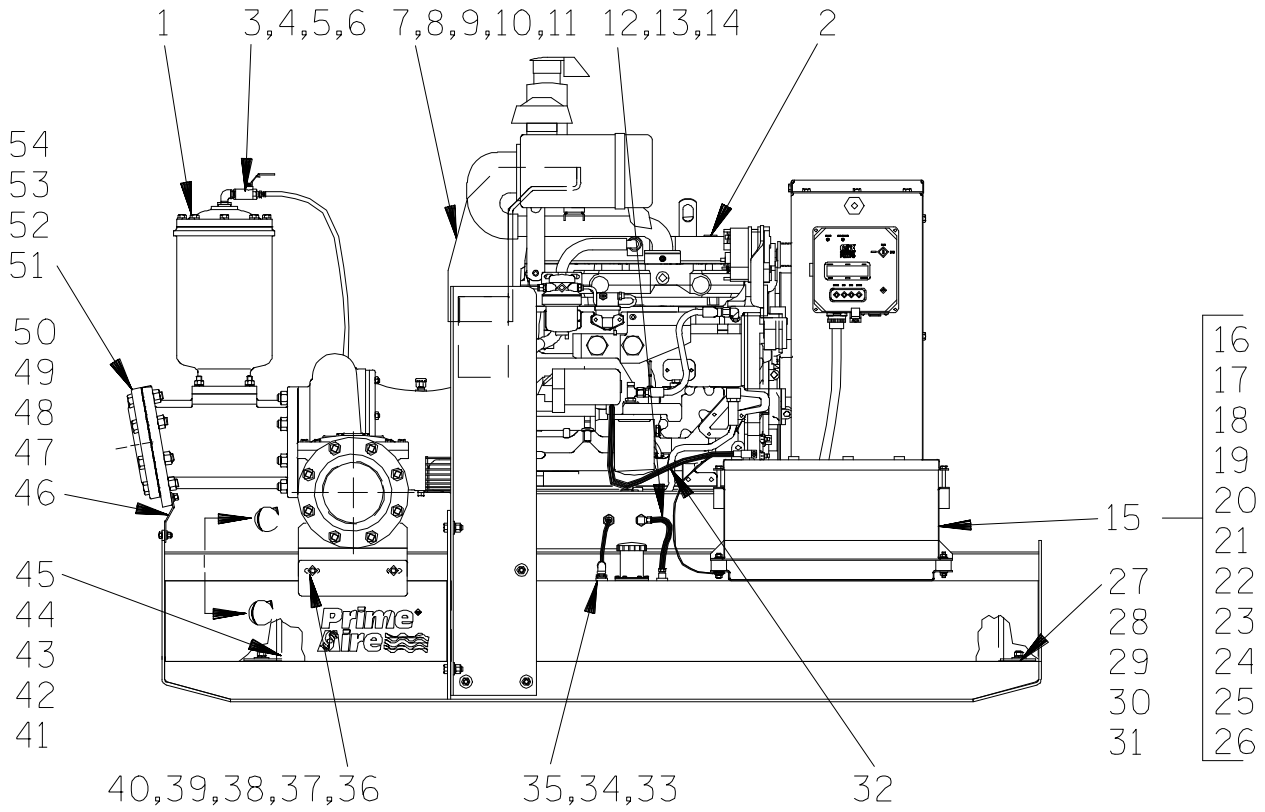

THE GORMAN-RUPP COMPANY • MANSFIELD, OHIO

GORMAN-RUPP OF CANADA LIMITED • ST. THOMAS, ONTARIO, CANADA

Printed in U.S.A.

S/N 1326702 Up
PUMP ISSUE 5

PARTS LIST
Pump Model PA6A60-4045D

If your pump serial number is followed by an "N", your pump is **NOT** a standard production model. Contact the Gorman-Rupp Company to verify part numbers.

ITEM NO.	PART NAME	PART NUMBER	MAT'L CODE	QTY	ITEM NO.	PART NAME	PART NUMBER	MAT'L CODE	QTY
1	PUMP ASSEMBLY	PA6A60-(SAE 4/10)		1	33	HOSE BARB FITTING	26523-386	----	2
2	J D 4045D ENGINE	29224-113	----	1	34	HOSE	11308H	----	1
3	REDUCER BUSHING	AP1608	11999	1	35	HOSE CLAMP	26518-641	----	2
4	BARB HOSE FITTING	26523-047	----	1	36	CHECK VALVE BRKT	34518-017	15120	1
5	MALE CONNECTOR	S1598	----	1	37	HEX HD CAPSCREW	B0604	15991	2
6	1/2" BRAIDED HOSE (3.25')	18513-113	----	1	38	HEX NUT	D06	15991	2
7	LIFTING BAIL	44711-020	24150	1	39	LOCKWASHER	J06	15991	2
8	HEX HD CAPSCREW	B0805	15991	10	40	FLAT WASHER	K06	15991	4
9	HEX NUT	D08	15991	6	41	FUEL TANK RETAINER	33541-039	15120	1
10	LOCKWASHER	J08	15991	10	42	HEX HD CAPSCREW	B0806	15991	2
11	FLAT WASHER	K08	15991	12	43	HEX NUT	D08	15991	2
12	MALE CONNECTOR	S1447	----	1	44	LOCKWASHER	J08	15991	2
13	MALE ELBOW	26351-131	----	1	45	FLAT WASHER	K08	15991	2
14	HOSE ASSY	46341-789	----	1	46	PRIM CHAMBER BRKT	34535-010	15120	1
15	BATTERY BOX ASSY	GRP40-08C	----	1	47	HEX HD CAPSCREW	B0604	15991	3
16	-HEX HD CAPSCREW	B0607	15991	2	48	HEX NUT	D06	15991	2
17	-FLAT WASHER	KE06	15991	2	49	LOCKWASHER	J06	15991	3
18	-FLANGED HEX NUT	21765-314	----	2	50	FLAT WASHER	K06	15991	3
19	-GRND CABLE ASSY	47311-064	----	1	51	SUCTION FLANGE	1758	10010	1
20	-BATTERY BOX LID	42113-012	24150	1	52	SUCT FLANGE GSKT	1679G	18000	1
21	-12V BATTERY	SEE OPTIONS LIST	REF		53	HEX HD CAPSCREW	B1212	15991	8
22	-BATTERY TAG	38818-506	----	1	54	HEX NUT	D12	15991	8
23	-BATTERY BOX	42431-030	24150	1	55	DISCHARGE FLANGE	1758	10010	1
24	-STUD MOUNT	24631-006	----	4	56	DISCH FLANGE GSKT	1679G	18000	1
25	-FLANGED HEX NUT	21765-314	----	8	57	HEX HD CAPSCREW	B1213	15991	8
26	T-TYPE LOCKWASHER	BL06	15991	1	58	HEX NUT	D12	15991	8
27	A/C FUEL TANK RET	33541-039	15120	1	59	SKID ASSY	41565-570	24150	1
28	HEX HD CAPSCREW	B0806	15991	2	60	VENTURI GUARD ASSY	42381-067	----	1
29	HEX NUT	D08	15991	2	61	HEX HD CAPSCREW	B0504	15991	2
30	LOCKWASHER	J08	15991	2	62	LOCKWASHER	J05	15991	2
31	FLAT WASHER	K08	15991	2	63	FLAT WASHER	K05	15991	2
32	I/O CABLE ASSY	47311-107	----	1	64	MUFFLER GRD ASSY	42331-057	----	1

* INDICATES PARTS RECOMMENDED FOR STOCK

THE GORMAN-RUPP COMPANY • MANSFIELD, OHIO

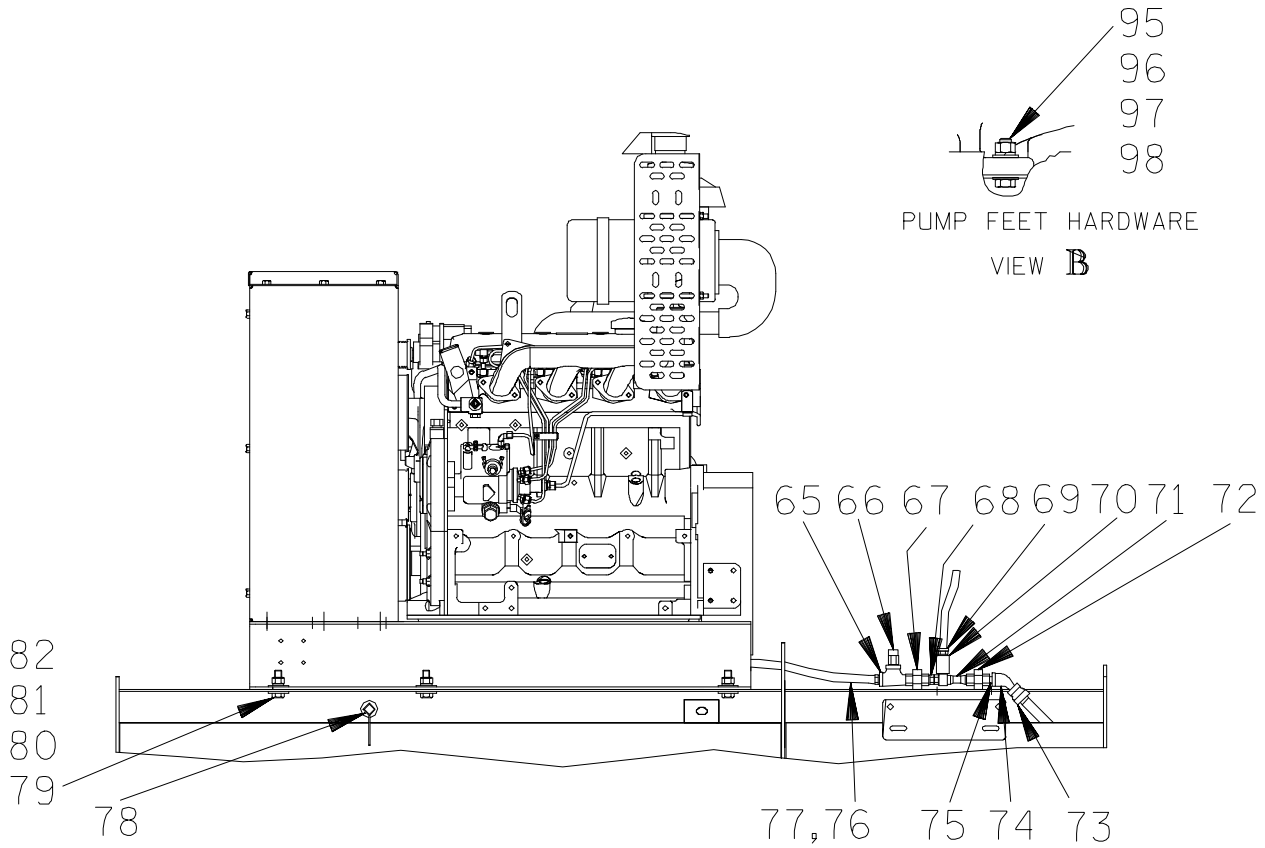

VIEW A-A
VENTURI SYSTEM

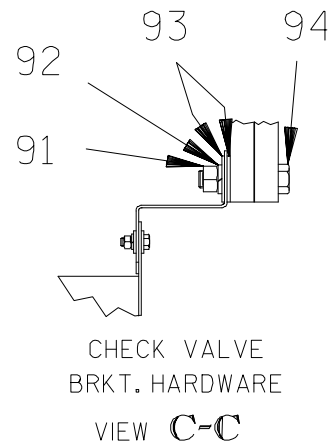
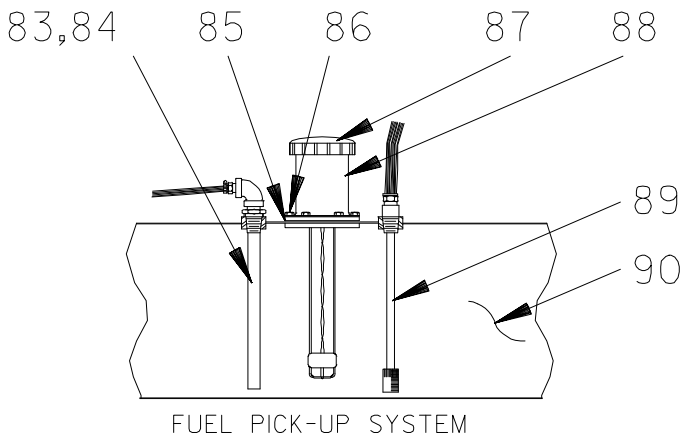

S/N 1326702 Up
PUMP ISSUE 5

PARTS LIST
Pump Model PA6A60-4045D

ITEM NO.	PART NAME	PART NUMBER	MAT'L CODE	QTY	ITEM NO.	PART NAME	PART NUMBER	MAT'L CODE	QTY
65	SERVICE TEE	US08	11999	1	97	LOCK WASHER	J08	15991	2
66	RELIEF VALVE	26662-028	----	1	98	HEX NUT	D08	15991	2
67	PIPE UNION	AH08	11999	1	NOT SHOWN:				
68	REDUCER BUSHING	AP0806	15079	1					
69	MALE HOSE END	26525-020	----	1		WARNING DECAL	38816-063	----	1
70	PIPE COUPLING	AE08	15079	1		LUBE DECAL	38816-079	----	REF
71	VENTURI	26817-002	----	1		SUCTION STICKER	6588AG	----	REF
72	PIPE UNION	AH08	11999	1		DISCHARGE STICKER	6588BJ	----	REF
73	RED PIPE BUSHING	AE1208	15079	1		RPM DECAL	2613FJ	----	1
74	45° STREET ELBOW	AGS08	11999	1		WARNING DECAL	38816-330	----	2
75	PIPE NIPPLE	T08	15079	1		LIFT DECAL	38816-218	----	2
76	HOSE ASSY	46341-422	----	1		PA DECAL	38812-078	----	2
77	MALE ADAPTER	26351-065	----	2		WARNING DECAL	2613FE	----	REF
78	OIL DRAIN ASSY	46342-013	----	1		G-R DECAL	GR-06	----	2
79	HEX HD CAPSCREW	B1007	15991	6		INSTR TAG PAPER	38817-085	----	1
80	HEX NUT	D10	15991	6		ENG START-UP TAG	38816-269	----	1
81	LOCKWASHER	J10	15991	6		NAME PLATE	38818-127	13000	REF
82	FLAT WASHER	K10	15991	12		DRIVE SCREW	BM#04-03	17000	REF
83	FUEL RETURN ASSY	46331-015	24150	1		STRAINER	7823A	24000	1
84	PIPE ELBOW	R04	11999	1		INSTRUCTION DECAL	38818-144	----	1
85	FILLER NECK GASKET	38683-270	19060	1		OIL LEVEL DECAL	38816-123	----	REF
86	HEX HD CAPSCREW	B#10-02S	15991	6		WARNING DECAL	38816-203	----	4
87	FILL CAP	29332-133	----	1		FLOAT SWITCH KIT	48312-980	----	1
88	FILLER NECK	29332-152	----	1	OPTIONAL:				
89	FUEL PICK-UP	29332-143	----	1					
90	FUEL TANK ASSY	46711-082	----	1		* 12V BATTERY	29331-506	----	1
91	HEX NUT	D12	15991	2		WHEEL KIT	GRP30-249A	----	1
92	LOCK WASHER	J12	15991	2	HIGHWAY TRAILER:				
93	FLAT WASHER	K12	15991	4		-2" BALL COUPLER	41583-776	----	1
94	HEX HD CAPSCREW	B1214	15991	2		-3" I.D. PINTLE EYE	41583-777	----	1
95	HEX HD CAPSCREW	B0808	15991	2	EPS W/TRANSDUCER AUTOSTART CONTROL PANEL				
96	FLAT WASHER	K08	15991	4		INSTALLATION KIT	48122-523	----	1

* INDICATES PARTS RECOMMENDED FOR STOCK

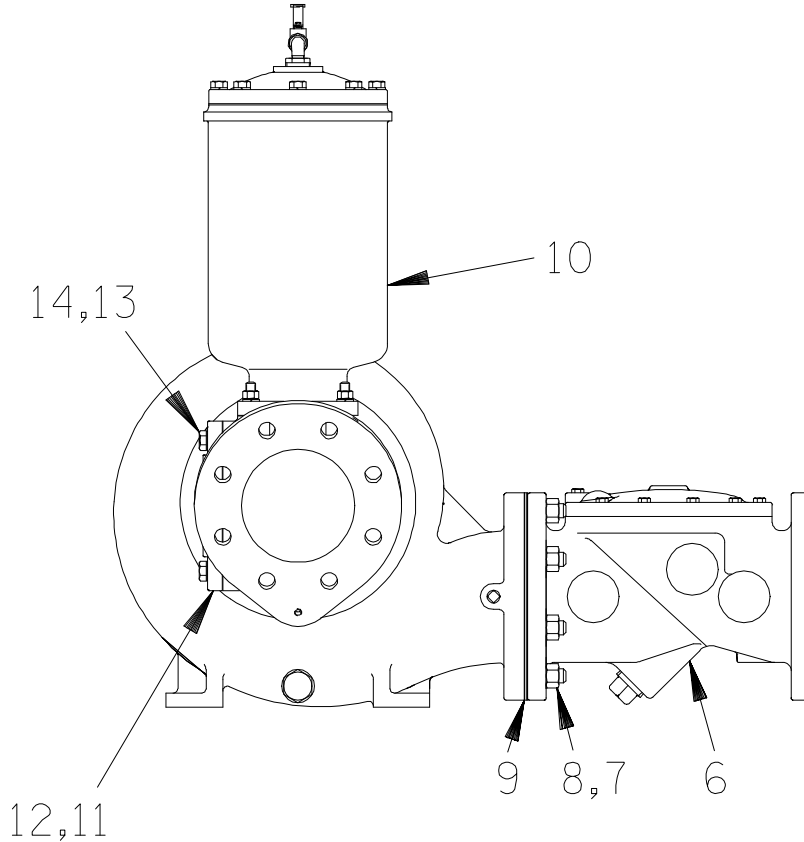
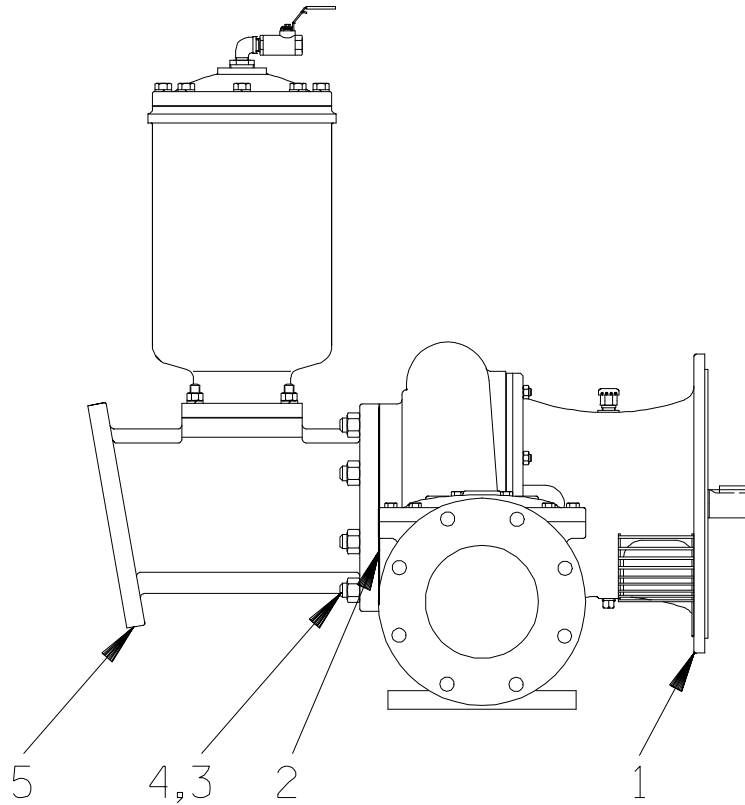

THE GORMAN-RUPP COMPANY • MANSFIELD, OHIO

GORMAN-RUPP OF CANADA LIMITED • ST. THOMAS, ONTARIO, CANADA

Printed in U.S.A.

S/N 1326702 Up
PUMP ISSUE 5

PARTS LIST
PA6A60-(SAE 4/10) Pump Assembly

ITEM NO.	PART NAME	PART NUMBER	MAT'L CODE	QTY
1	PUMP END ASSY	66E60-(SAE4/10)	---	1
2	* PUMP CASING GSKT	1679G	18000	1
3	STUD	C1211	15991	8
4	HEX NUT	D12	15991	8
5	6" HOPPER SPOOL	38642-507	10000	1
6	CHECK VALVE ASSY	26642-126	---	1
	-FLAPPER	26688-001	---	1
	-O-RING	25152-377	---	1
7	STUD	C1211	15991	8
8	HEX NUT	D12	15991	8
9	* CHECK VALVE GASKET	25113-036	---	1
10	PRIMING CHAMBER ASSY	48275-005	---	1
11	4" BLIND FLANGE	25353-908	---	1
12	4" GASKET	25113-034	---	1
13	HEX HEAD CAP SCREW	B1008	15991	8
14	LOCKWASHER	J10	15991	8

NOT SHOWN:

G-R DECAL	GR-06	---	1
LUBE DECAL	38816-079	---	1
SUCTION STICKER	6588AG	---	1
DISCHARGE STICKER	6588BJ	---	1
WARNING DECAL	2613FE	---	1

* INDICATES PARTS RECOMMENDED FOR STOCK

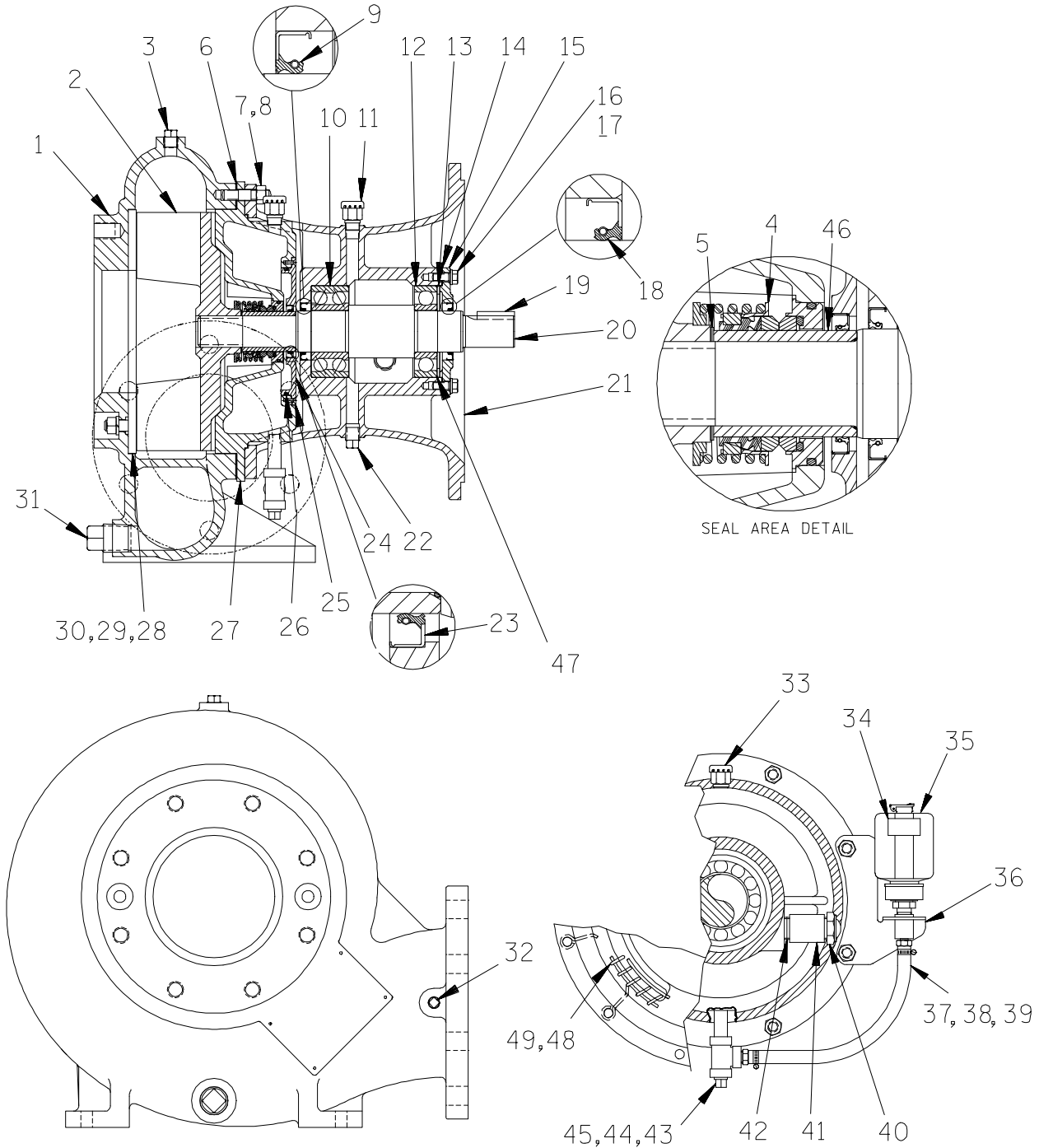

THE GORMAN-RUPP COMPANY • MANSFIELD, OHIO

GORMAN-RUPP OF CANADA LIMITED • ST. THOMAS, ONTARIO, CANADA

Printed in U.S.A.

S/N 1326702 Up
PUMP ISSUE 5

PARTS LIST
66E60-(SAE4/10) Pump End Assembly

ITEM NO.	PART NAME	PART NUMBER	MAT'L CODE	QTY	ITEM NO.	PART NAME	PART NUMBER	MAT'L CODE	QTY
1	PUMP CASING	38218-014	10000	1	28 *	WEAR PLATE ASSY	46451-746	24150	1
2 *	IMPELLER ASSY	46151-409	---	1	29	HEX NUT	D08	15991	2
3	PIPE PLUG	P06	15079	1	30	LOCKWASHER	J08	15991	2
4 *	SEAL ASSY	46512-048	---	1	31	PIPE PLUG	P16	10009	1
5 *	ADJ SHIM SET	5091	17090	1	32	PIPE PLUG	P04	15079	1
6 *	CASING GASKET SET	34G	18000	1	33	AIR VENT	S1703	---	1
7	STUD	C0809	15991	8	34	OIL LEVEL DECAL	38816-123	---	1
8	HEX NUT	D08	15991	8	35	BOTTLE OILER	26713-004	---	1
9 *	OIL SEAL	25258-622	---	1	36	BOTTLE OILER BRKT	41881-619	24150	1
10 *	INBOARD BALL BEARING	23421-461	---	1	37	MALE CONNECTOR	26523-409	---	2
11	AIR VENT	S1703	---	1	38	HOSE	18513-054	---	1
12 *	OUTBOARD BALL BRG	S1077	---	1	39	HOSE CLAMP	26518-642	---	2
13	THRUST WASHER	31133-197	15210	1	40	OIL LVL SIGHT GAUGE	S1471	---	1
14 *	BRG COVER GSKT	5413G	18000	1	41	PIPE COUPLING	AE12	15079	1
15	BEARING CAP	4185A	10010	1	42	PIPE NIPPLE	T12	15079	1
16	HEX HD CAPSCREW	B0604	15991	4	43	PIPE NIPPLE	T0608	15079	1
17	LOCKWASHER	J06	15991	4	44	PIPE TEE	U06	11999	1
18 *	OIL SEAL	25258-622	---	1	45	SEAL CVTY DRAIN PLUG	P06	15079	1
19 *	IMP SHAFT KEY	N0607	15990	1	46 *	SHAFT SLEEVE	31163-016	1706H	1
20 *	IMPELLER SHAFT	38514-807	1706H	1	47 *	BRG SHIM SET	8546	15990	1
21	INTERMEDIATE	38263-614	10010	1	48	INTERMEDIATE GUARD	42381-031	24152	1
22	BRG CAV DRAIN PLUG	P06	15079	1	49	INTERMEDIATE GUARD	42381-032	24152	1
23 *	OIL SEAL	25258-620	---	1	NOT SHOWN:				
24	SEAL PLATE COVER	38242-707	10000	1		DRIVE ASSY	44162-119	---	1
25	FH MACHINE SCREW	Y#10-02	15991	4		NAME PLATE	38818-127	13000	1
26 *	SEAL PLATE O-RING	25152-256	---	1		DRIVE SCREW	BM#04-03	17000	4
27	SEAL PLATE	38272-527	10000	1					

INDICATES PARTS RECOMMENDED FOR STOCK

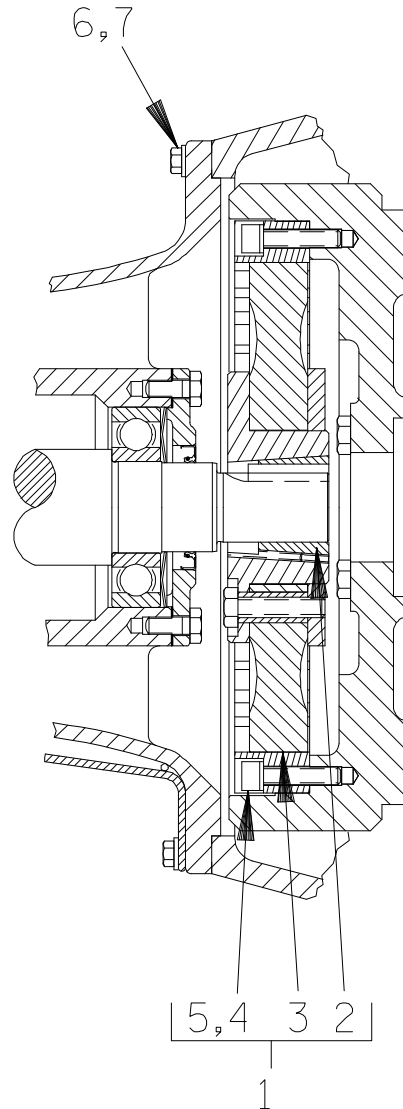

PARTS LIST
(SAE4/10) Drive Assembly

ITEM NO.	PART NAME	PART NUMBER	MAT'L CODE	QTY
1	COUPLING KIT	48112-001	---	1
2	-BUSHING	24131-345	---	1
3	-COUPLING ASSEMBLY	44165-011	---	1
4	-LOCKWASHER	21171-536	---	8
5	-SOCKET HD CAPSCREW	22644-220	---	8
6	HEX HD CAPSCREW	B0605	---	12
7	LOCKWASHER	J06	---	12

THE GORMAN-RUPP COMPANY • MANSFIELD, OHIO

GORMAN-RUPP OF CANADA LIMITED • ST. THOMAS, ONTARIO, CANADA

Printed in U.S.A.

S/N 1326702 Up
PUMP ISSUE 5

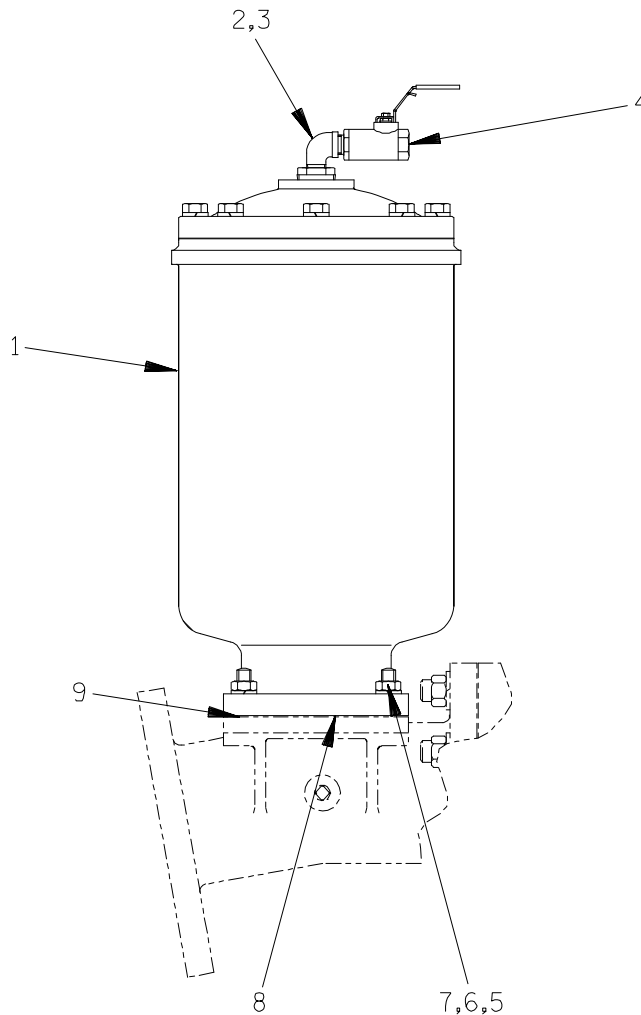

PARTS LIST
48275-005 Priming Chamber Kit

ITEM NO.	PART NAME	PART NUMBER	MAT'L CODE	QTY
1	PRIMING HOPPER ASSY	46112-709	---	1
2	PIPE BUSHING	AP1608	11999	1
3	STREET ELBOW	RS08	11999	1
4	BALL VALVE	26631-052	---	1
5	STUD	C0809	15991	4
6	HEX NUT	D08	15991	4
7	LOCK WASHER	J08	15991	4
8	* GASKET	38687-053	19060	1
9	BAFFLE	31113-011	17000	1

* INDICATES PARTS RECOMMENDED FOR STOCK

THE GORMAN-RUPP COMPANY • MANSFIELD, OHIO

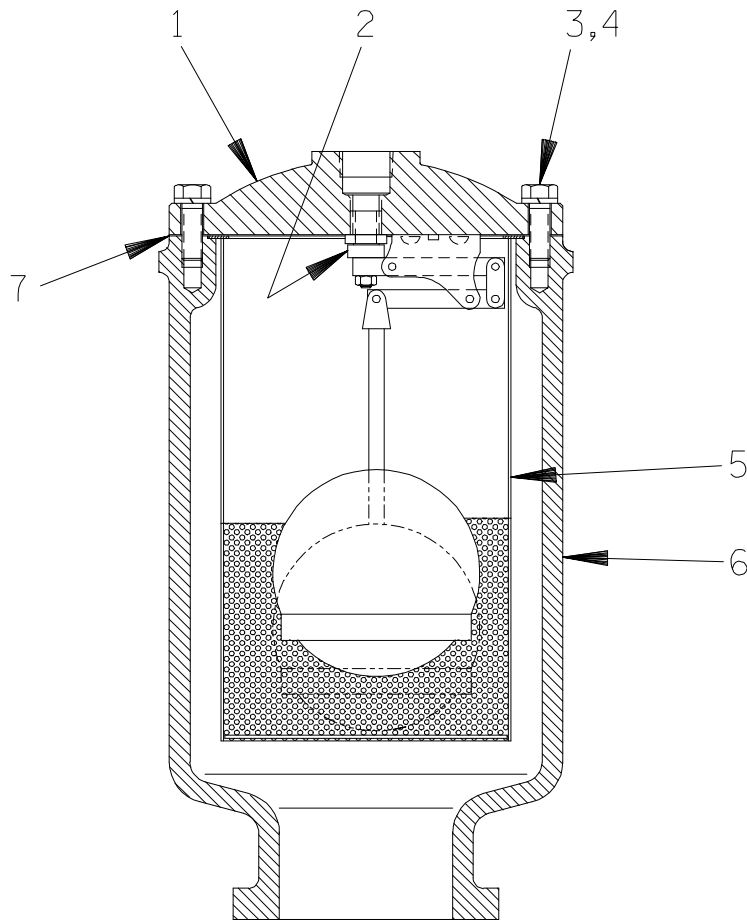

PARTS LIST
46112-709 Priming Chamber Assembly

ITEM NO.	PART NAME	PART NUMBER	MAT'L CODE	QTY
1	PRIMING VALVE	26664-007	---	1
2	-ORIFICE BUTTON	26688-021	---	1
3	HEX HD CAPSCREW	B0806	15991	8
4	LOCKWASHER	J08	15991	8
5	STRAINER ASSY	46641-222	17000	1
6	PRIMING CHAMBER	38343-020	10000	1
7	* PRIMING VALVE GASKET	38683-657	19060	1

* INDICATES PARTS RECOMMENDED FOR STOCK

**For U.S. and International Warranty Information,
Please Visit www.grpumps.com/warranty
or call:
U.S.: 419-755-1280
International: +1-419-755-1352**

**For Canadian Warranty Information,
Please Visit www.grcanada.com/warranty
or call:
519-631-2870**